



MAS 403 BT
MAS 403 BT/B
Attacchi con cono ISO
Attachments
with ISO cone

3



www.mecadiffusion.com



3. MANDRINI a cono ISO MAS 403 BT

TOOL HOLDERS with ISO cone MAS 403 BT



ACCESSORI PER MACCHINE UTENSILI

MAS 403 BT



Attacchi MAS 403 BT

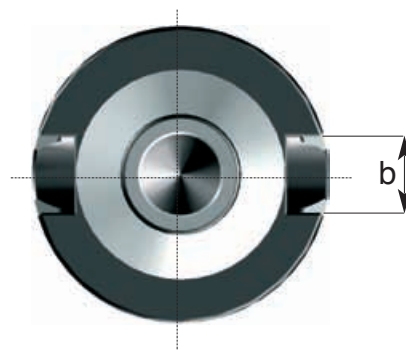
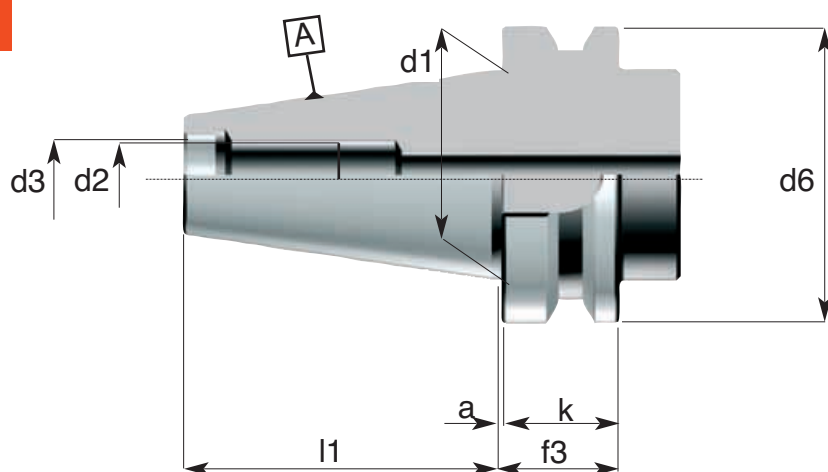

Riferimento Item	a	b H12	d1	d2	d3 H8	d6	f3	l1	k
BT 30	2	16.1	31.75	M12	12.5	46	22	48.4	20
BT 35	2	16.1	38.10	M12	13	53	22	56.4	20
BT 40	2	16.1	44.45	M16	17	63	27	65.4	25
BT 50	3	25.7	69.85	M24	25	100	37	101.8	35

CARATTERISTICHE TECNICHE DEI MANDRINI TC

- Costruiti in acciaio da cementazione legato
- Cementati con profondità 0,8-1mm
Temprati • Rinvenuti • Sabbati e bruniti
- Durezza HRC 58±2 • Resistenza al nucleo 800-1000 N/mm²
- Rettificati di precisione esternamente, internamente e nelle filettature delle ghiere chiudipinza
- Controllati con strumenti di misura certificati
- La tolleranza di precisione dei coni ISO è inferiore ad AT3

STANDARD FEATURES OF TC TOOLING

- Manufactured with Nickel Chrome Molybdenum steel
- Carburized with depth of case 0,8-1 mm
•Hardened and tempered •Black oxidized
- Surface Hardness RC 58±2 • Tensile strenght of core 800-1000 N/mm²
- Precision ground on shanks, inside tapers and collet nut threads
- Tested with high precision inspection and gaging equipment
- Taper accuracy of ISO SHANKS lower than AT3

ACCESSORI PER MACCHINE UTENSILI

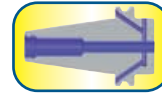

MAS 403 BT-B

Attacchi MAS 403 BT

Sez. A-A

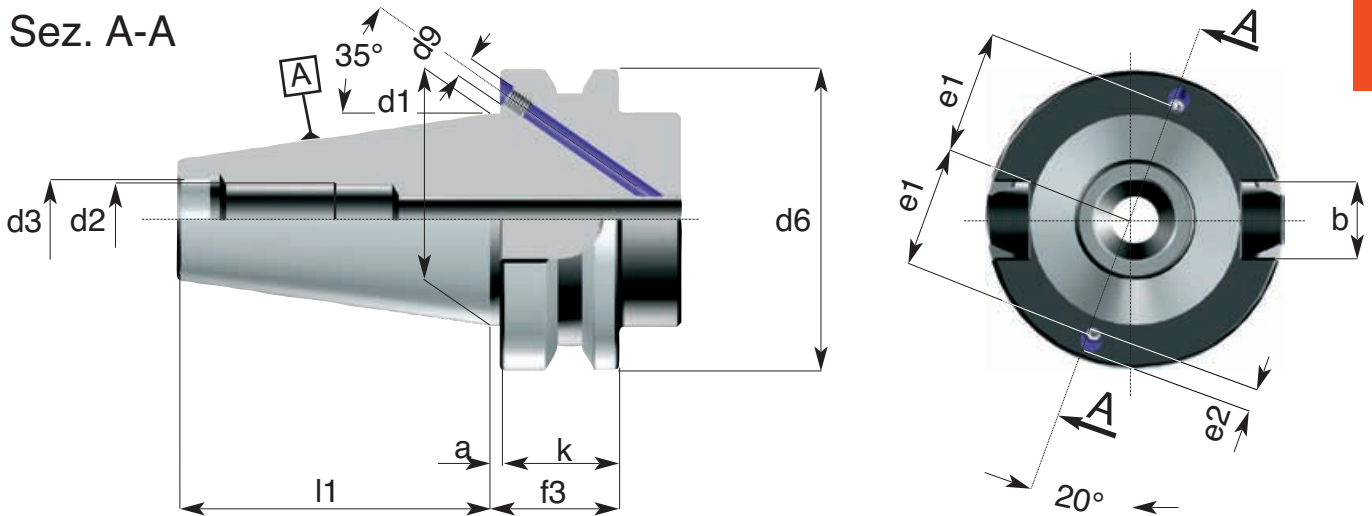

3.
3

Riferimento Item	a	b H12	d1	d2	d3 H7	d6	f3	l1	k	e1	e2	d9
BT 40	2	16.1	44.45	M16	17	63	27	65.4	25	35	5	4
BT 50	3	25.7	69.85	M24	25	100	37	101.8	35	42	7	6

CARATTERISTICHE TECNICHE DEI MANDRINI TC

- Costruiti in acciaio da cementazione legato
- Cementati con profondità 0,8-1mm
Temprati • Rinvenuti • Sabbiati e bruniti
- Durezza HRC 58±2 • Resistenza al nucleo
800-1000 N/mm²
- Rettificati di precisione esternamente,
internamente e nelle filettature delle ghiera
chiodipinza
- Controllati con strumenti di misura certificati
- La tolleranza di precisione dei coni ISO è
inferiore ad AT3

STANDARD FEATURES OF TC TOOLING

- Manufactured with Nickel Chrome Molybdenum
steel
- Carburized with depth of case 0,8-1 mm
•Hardened and tempered •Black oxidized
- Surface Hardness RC 58±2 •Tensile strenght
of core 800-1000 N/mm²
- Precision ground on shanks, inside tapers and
collet nut threads
- Tested with high precision inspection and
gaging equipment
- Taper accuracy of ISO SHANKS lower than AT3

3. MANDRINI a cono ISO MAS 403 BT

TOOL HOLDERS with ISO cone MAS 403 BT



Portafrese combinati trascinamento frontale e a chiave DIN 6358 B

Combined milling cutter chucks DIN 6358 B

Kombi-Aufsteckfräserdorne DIN 6358 B

Mandrins porte-fraises combinés DIN 6358 B

ACCESSORI PER MACCHINE UTENSILI

MAS 403 BT



Prebilanciato
Prebalanced
G6.3 / 8000rpm



ART: 130 BT

3
4

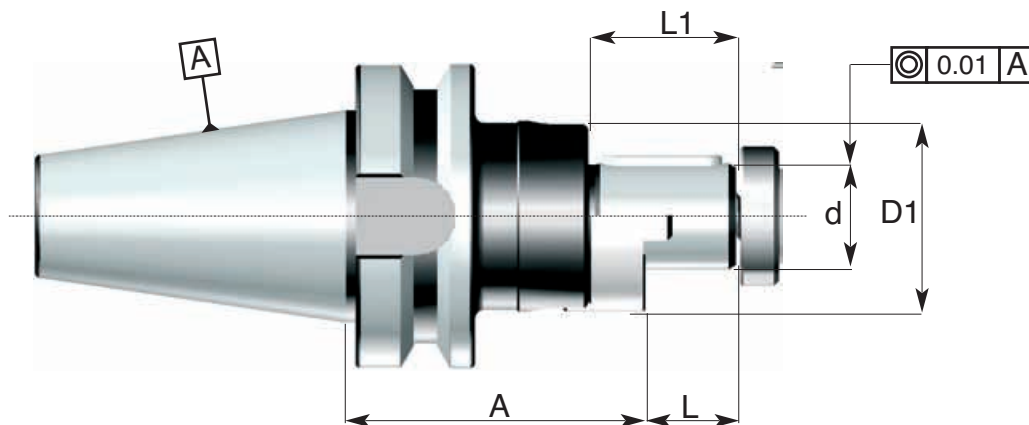
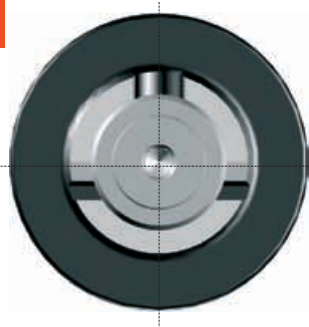

Codice di ord Code	SK	d h6	A	L	L1	D1	Trascinatore Ring	Vite Screw	Linguetta Key
060.130.30.0160	SK 30	16	50	17	27	32	190.01	191.01	130.199.01
060.130.30.0220	SK 30	22	50	19	31	40	190.02	191.02	130.199.02
060.130.30.0270	SK 30	27	50	21	33	48	190.03	191.03	130.199.03
061.130.35.0160	SK 35	16	50	17	27	32	190.01	191.01	130.199.01
061.130.35.0220	SK 35	22	50	19	31	40	190.02	191.02	130.199.02
061.130.35.0270	SK 35	27	50	21	33	48	190.03	191.03	130.199.03
061.130.35.0320	SK 35	32	55	24	38	58	190.04	191.04	130.199.04
063.130.40.0160	SK 40	16	50	17	27	32	190.01	191.01	130.199.01
063.130.40.0162	SK 40	16	90	17	27	32	190.01	191.01	130.199.01
063.130.40.0220	SK 40	22	55	19	31	40	190.02	191.02	130.199.02
063.130.40.0222	SK 40	22	90	19	31	40	190.02	191.02	130.199.02
063.130.40.0270	SK 40	27	55	21	33	48	190.03	191.03	130.199.03
063.130.40.0272	SK 40	27	90	21	33	48	190.03	191.03	130.199.03
063.130.40.0320	SK 40	32	60	24	38	58	190.04	191.04	130.199.04
063.130.40.0322	SK 40	32	90	24	38	58	190.04	191.04	130.199.04
063.130.40.0400	SK 40	40	60	27	41	70	190.05	191.05	130.199.05
063.130.40.0402	SK 40	40	90	27	41	70	190.05	191.05	130.199.05
065.130.50.0160	SK 50	16	65	17	27	32	190.01	191.01	130.199.01
065.130.50.0162	SK 50	16	120	17	27	32	190.01	191.01	130.199.01
065.130.50.0220	SK 50	22	65	19	31	40	190.02	191.02	130.199.02
065.130.50.0222	SK 50	22	120	19	31	40	190.02	191.02	130.199.02
065.130.50.0270	SK 50	27	70	21	33	48	190.03	191.03	130.199.03
065.130.50.0272	SK 50	27	120	21	33	48	190.03	191.03	130.199.03
065.130.50.0320	SK 50	32	70	24	38	58	190.04	191.04	130.199.04
065.130.50.0322	SK 50	32	120	24	38	58	190.04	191.04	130.199.04
065.130.50.0400	SK 50	40	75	27	41	70	190.05	191.05	130.199.05
065.130.50.0402	SK 50	40	120	27	41	70	190.05	191.05	130.199.05
065.130.50.0500	SK 50	50	75	30	46	90	190.06	191.06	130.199.06
065.130.50.0502	SK 50	50	120	30	46	90	190.06	191.06	130.199.06

Pag. 12.E4



Pag. 12.E5



ACCESSORI PER MACCHINE UTENSILI

Portafrese con trascinamento frontale per frese a manicotto DIN 138

Face milling cutter chucks DIN 138

Aufsteckfräserdome DIN 138

Mandrinis porte-fraises à surfacer DIN 138

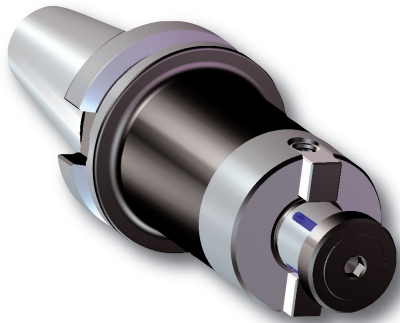

Prebilanciato
Prebalanced
G6.3 / 8000rpm



MAS 403 BT

ART: 150 BT

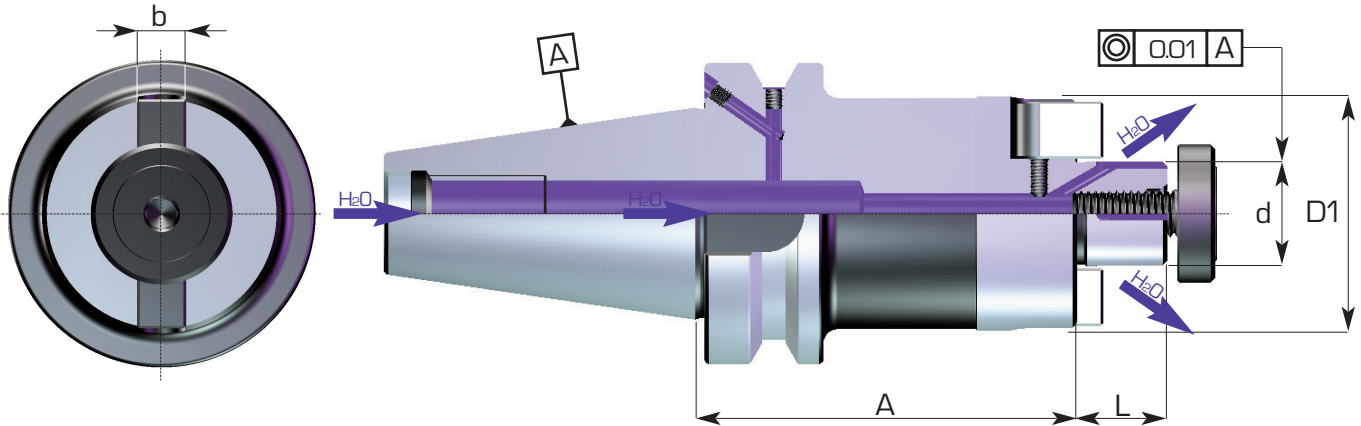

Codice di ord Code	SK	d h6	A	L	D1	b	Tassello Tenon	Vite Screw
H63.15040.016.060	SK 40	16	60	17	38	8	151.101	191.01
H63.15040.016.100	SK 40	16	100	17	38	8	151.101	191.01
H63.15040.022.060	SK 40	22	60	19	49	10	151.102	191.02
H63.15040.022.100	SK 40	22	100	19	49	10	151.102	191.02
H63.15040.022.127	SK 40	22	127	19	49	10	151.102	191.02
H63.15040.022.177	SK 40	22	177	19	49	10	151.102	191.02
*O63.15040.022.227	SK 40	22	227	19	49	10	151.102	191.02
H63.15040.027.045	SK 40	27	45	21	60	12	151.103	191.03
H63.15040.027.100	SK 40	27	100	21	60	12	151.103	191.03
H63.15040.027.127	SK 40	27	127	21	60	12	151.103	191.03
H63.15040.027.177	SK 40	27	177	21	60	12	151.103	191.03
*O63.15040.027.227	SK 40	27	227	21	60	12	151.103	191.03
H63.15040.032.060	SK 40	32	60	24	64.5	14	151.104	191.04
H63.15040.040.100	SK 40	40	100	27	74.5	16	151.105.R14	191.05
H65.15050.016.075	SK 50	16	75	17	38	8	151.101	191.01
H65.15050.022.075	SK 50	22	75	19	49	10	151.102	191.02
H65.15050.022.100	SK 50	22	100	19	49	10	151.102	191.02
H65.15050.022.188	SK 50	22	188	19	49	10	151.102	191.02
*O65.15050.022.238	SK 50	22	238	19	49	10	151.102	191.02
*O65.15050.022.338	SK 50	22	338	19	49	10	151.102	191.02
H65.15050.027.060	SK 50	27	60	21	60	12	151.103	191.03
H65.15050.027.100	SK 50	27	100	21	60	12	151.103	191.03
H65.15050.027.188	SK 50	27	188	21	60	12	151.103	191.03
*O65.15050.027.238	SK 50	27	238	21	60	12	151.103	191.03
*O65.15050.027.338	SK 50	27	338	21	60	12	151.103	191.03
H65.15050.032.075	SK 50	32	75	24	75	14	151.104	191.04
H65.15050.032.100	SK 50	32	100	24	75	14	151.104	191.04
H65.15050.040.060	SK 50	40	60	27	85	16	151.105	191.05
H65.15050.040.100	SK 50	40	100	27	85	16	151.105	191.05

Pag. 12/27



Pag. 12/25



3. MANDRINI a cono ISO MAS 403 BT

TOOL HOLDERS with ISO cone MAS 403 BT



Portafrese con trascinamento frontale e linguetta DIN 138

Face milling cutter chucks DIN 138

Aufsteckfräserdorne DIN 138

Mandrins porte-fraises à surfacer DIN 138

ACCESSORI PER MACCHINE UTENSILI

MAS 403 BT



Prebilanciato
Prebalanced
G6.3 / 8000rpm



ART: 151 BT

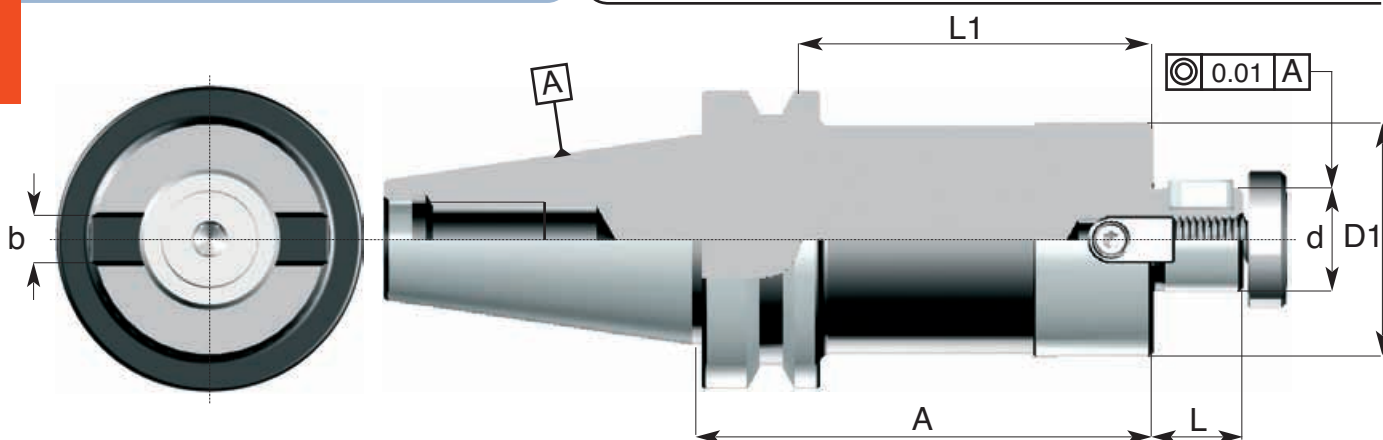

Codice di ord Code	SK	d h6	A	L	L1	D1	b	Tassello Tenon	Vite Screw	Linguetta Key
063.151.40.0222	SK 40	22	127	19	100	49	10	151.102	191.02	151.199.02
063.151.40.0224	SK 40	22	177	19	150	49	10	151.102	191.02	151.199.02
063.151.40.0226	SK 40	22	227	19	200	49	10	151.102	191.02	151.199.02
063.151.40.0272	SK 40	27	127	21	100	60	12	151.103	191.03	151.199.03
063.151.40.0274	SK 40	27	177	21	150	60	12	151.103	191.03	151.199.03
063.151.40.0276	SK 40	27	227	21	200	60	12	151.103	191.03	151.199.03
065.151.50.0222	SK 50	22	188	19	150	49	10	151.102	191.02	151.199.02
065.151.50.0224	SK 50	22	238	19	200	49	10	151.102	191.02	151.199.02
065.151.50.0226	SK 50	22	338	19	300	49	10	151.102	191.02	151.199.02
065.151.50.0272	SK 50	27	188	21	150	60	12	151.103	191.03	151.199.03
065.151.50.0274	SK 50	27	238	21	200	60	12	151.103	191.03	151.199.03
065.151.50.0276	SK 50	27	338	21	300	60	12	151.103	191.03	151.199.03



ARTICOLO DISPONIBILE FINO AD ESAURIMENTO SCORTE.
SOSTITUITO DA 063/H63.150 E 065/H65.150

ACCESSORI PER MACCHINE UTENSILI

Portafrese trascinamento frontale per frese a inserti DIN 6357 B

Centering arbors for milling cutters DIN 6357 B

Aufnahmedorne für Messerköpfe DIN 6357 B

Mandrins porte-fraises pour têtes porte-lames DIN 6357 B

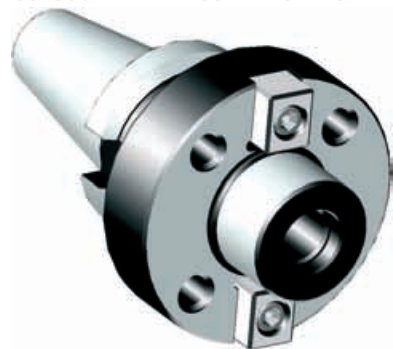

MAS 403 BT

ART: 160 BT

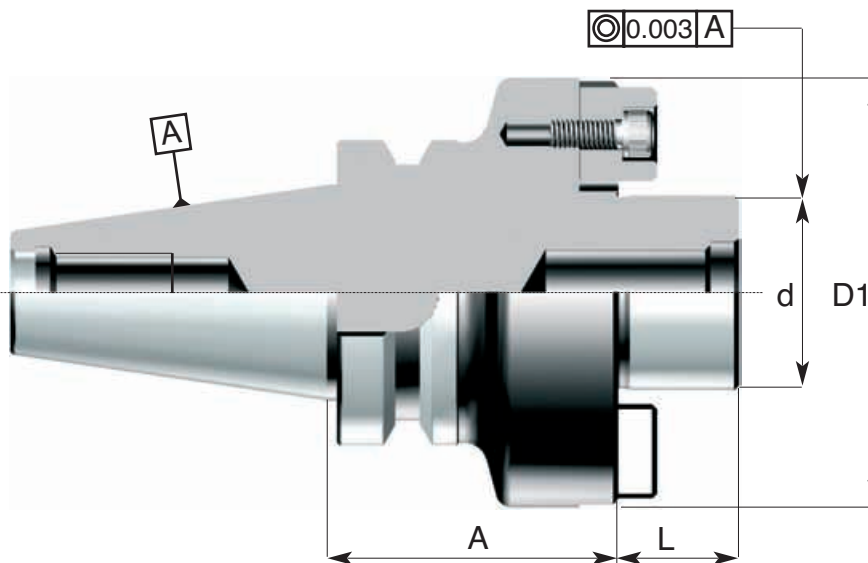
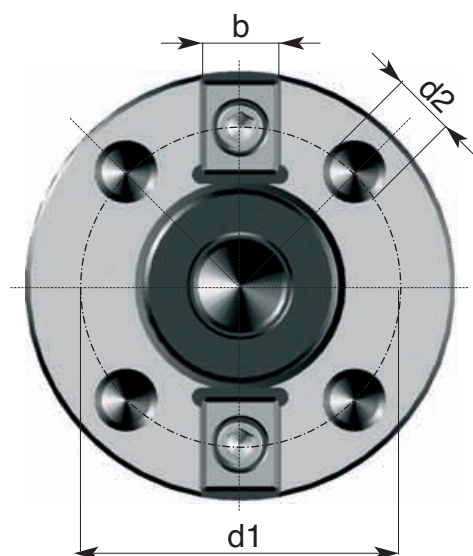

3.
7

Codice di ord Code	SK	D1 h6	d	A h6	d1	d2	L	b	Tassello Tenon
063.160.40.0880.40	SK 40	88.882	40	60	66.70	M 12	M 12	15.9	192.02
063.160.40.1280.60	SK 40	128.570	60	60	101.6	M 16	M 16	25.4	192.03
065.160.50.0880.40	SK 50	88.882	40	70	66.70	M 12	M 12	15.9	192.02
065.160.50.1280.60	SK 50	128.570	60	75	101.6	M 16	M 16	25.4	192.03

Pag. 12.26



3. MANDRINI a cono ISO MAS 403 BT TOOL HOLDERS with ISO cone MAS 403 BT



Portafrese cilindriche tipo weldon corto e tipo ribassato per punte

Milling cutter chucks for straight-shank tools Weldon System - short type and lowered type for drills
Spannfutter Weldon für Zylinderschäfte - kurze Ausführung und verringerte Ausführung für Bohrer
Mandrins porte-Weldon pour fraises à queue cylindrique - type court et type surbaissé pour forets

ACCESSORI PER MACCHINE UTENSILI

MAS 403 BT

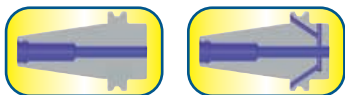

ART: 208 BT e 208.R BT

Prebilanciato
Prebalanced
G6.3 / 8000rpm

3
8

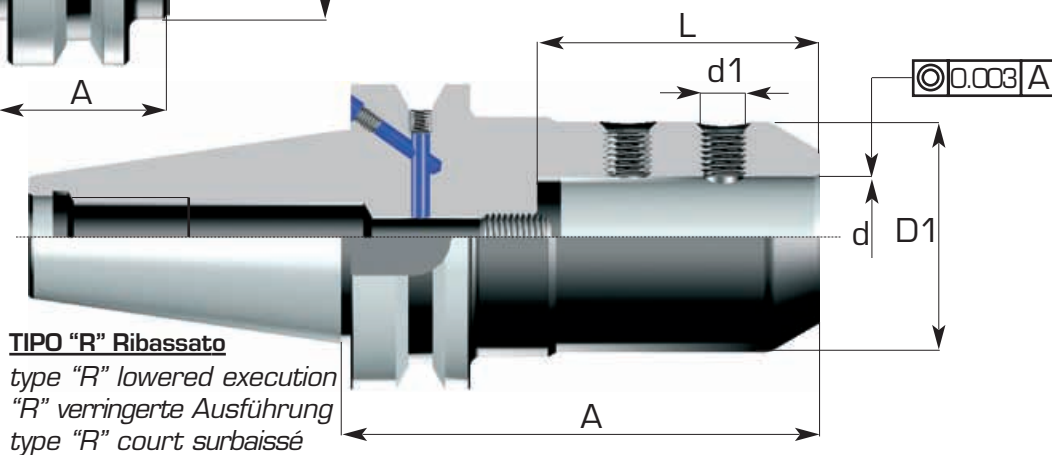
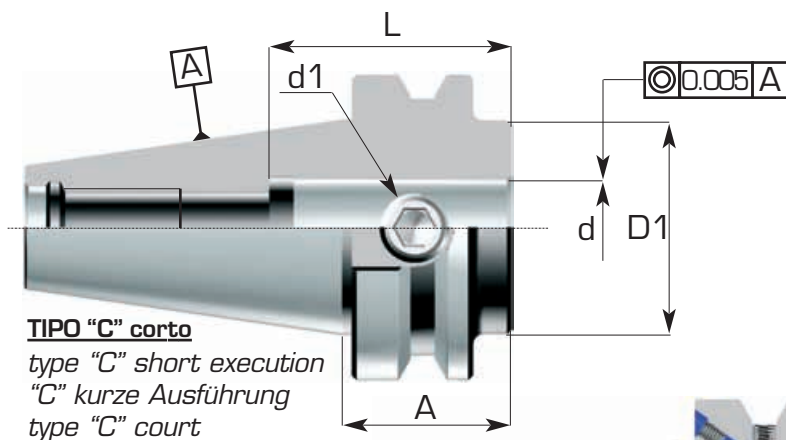

Codice di ord Code	SK	d H5	A	D1	L	d1	Grano di serraggio Clamping screw
063.208.40.0160.C	SK 40	16	35	44	45	M14X1.5	208.00.0140
063.208.40.0200.C	SK 40	20	35	44	45	M14X1.5	208.00.0140
063.208.40.0250.C	SK 40	25	35	44	55	M14X1.5	208.00.0140
063.208.40.0320.C	SK 40	32	70	72	60	M16X1 - 20X1.5	208.00.0161 - 208.00.0200
065.208.50.0160.C	SK 50	16	45	70	45	M14X1.5	208.00.0140
065.208.50.0200.C	SK 50	20	45	70	45	M16X1.5	208.00.0160
065.208.50.0250.C	SK 50	25	45	70	55	M18X1.5	208.00.0180
065.208.50.0320.C	SK 50	32	45	70	60	M20X1.5	208.00.0200
H63.208.40.0250.R	SK 40	25	100	45	59	M10X1	208.00.0100.R
H63.208.40.0320.R	SK 40	32	80	52	63	M12X1	208.00.0120.R
H63.208.40.0400.R	SK 40	40	87	63	73	M16X1	208.00.0160.R
H65.208.50.0320.R	SK 50	32	100	52	63	M12X1	208.00.0120.R
H65.208.50.0400.R	SK 50	40	115	65	73	M16X1	208.00.0160.R



ACCESSORI PER MACCHINE UTENSILI



Portafrese cilindriche tipo weldon con vite di registrazione interna DIN 6359 B
 Milling cutter chucks for straight-shank tools - Weldon System DIN 6359 B
 Spannfutter Weldon für Zylinderschäfte DIN 6359 B
 Mandrins porte-Weldon pour fraises à queue cylindrique DIN 6359 B

Prebilanciato
 Prebalanced
 G6.3 / 8000rpm



MAS 403 BT

ART: 208 BT

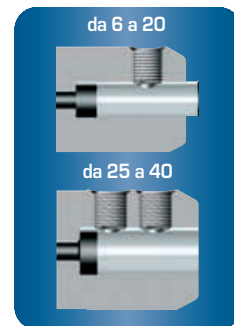
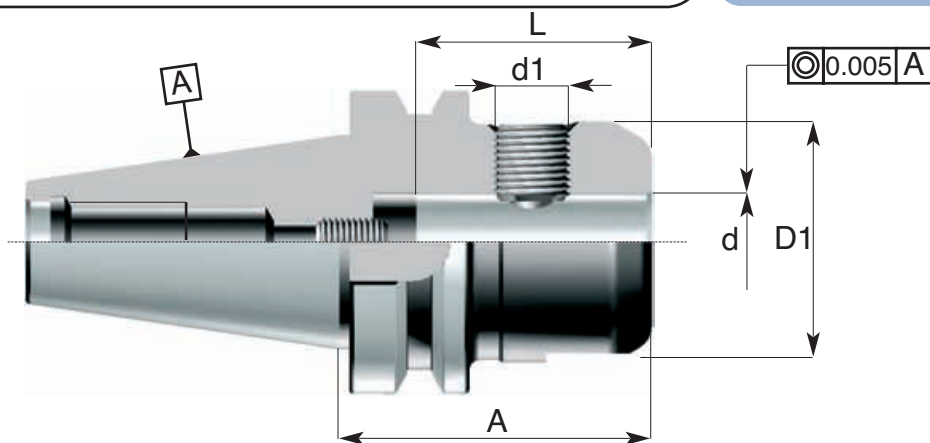

3.
9

Codice di ord Code	SK	d H5	A	D1	L	d1	Grano di serraggio Clamping screw
060.208.30.0060	SK 30	6	60	25	35	M6X10	208.00.0060
060.208.30.0080	SK 30	8	60	28	35	M8X10	208.00.0080
060.208.30.0100	SK 30	10	60	35	39	M10X12	208.00.0100
060.208.30.0120	SK 30	12	60	42	44	M12X1,5X16	208.00.0120
060.208.30.0160	SK 30	16	60	48	47	M14X1,5X16	208.00.0140
060.208.30.0200	SK 30	20	60	52	49	M16X1,5X16	208.00.0160
061.208.35.0060	SK 35	6	60	25	35	M6X10	208.00.0060
061.208.35.0080	SK 35	8	60	28	35	M8X10	208.00.0080
061.208.35.0100	SK 35	10	60	35	39	M10X12	208.00.0100
061.208.35.0120	SK 35	12	60	42	44	M12X1,5X16	208.00.0120
061.208.35.0160	SK 35	16	60	48	47	M14X1,5X16	208.00.0140
061.208.35.0200	SK 35	20	60	52	49	M16X1,5X16	208.00.0160
061.208.35.0250	SK 35	25	80	65	54	M18X1,5X20	208.00.0180
063.208.40.0060	SK 40	6	65	25	35	M6X10	208.00.0060
063.208.40.0080	SK 40	8	65	28	35	M8X10	208.00.0080
063.208.40.0100	SK 40	10	65	35	39	M10X12	208.00.0100
063.208.40.0120	SK 40	12	65	42	44	M12X1,5X16	208.00.0120
063.208.40.0140	SK 40	14	65	44	44	M12X1,5X16	208.00.0120
063.208.40.0160	SK 40	16	65	48	47	M14X1,5X16	208.00.0140
063.208.40.0180	SK 40	18	65	48	47	M14X1,5X16	208.00.0140
063.208.40.0200	SK 40	20	65	52	49	M16X1,5X16	208.00.0160
063.208.40.0250	SK 40	25	90	65	54	M18X1,5X20	208.00.0180
063.208.40.0320	SK 40	32	90	72	58	M20X1,5X20	208.00.0200
063.208.40.0400	SK 40	40	105	80	68	M20X1,5X20	208.00.0200
065.208.50.0060	SK 50	6	80	25	35	M6X10	208.00.0060
065.208.50.0080	SK 50	8	80	28	35	M8X10	208.00.0080
065.208.50.0100	SK 50	10	80	35	39	M10X12	208.00.0100
065.208.50.0120	SK 50	12	80	42	44	M12X1,5X16	208.00.0120
065.208.50.0140	SK 50	14	80	44	44	M12X1,5X16	208.00.0120
065.208.50.0160	SK 50	16	80	48	47	M14X1,5X16	208.00.0140
065.208.50.0180	SK 50	18	80	50	47	M14X1,5X16	208.00.0140
065.208.50.0200	SK 50	20	80	52	49	M16X1,5X16	208.00.0160
065.208.50.0250	SK 50	25	100	65	54	M18X1,5X20	208.00.0180
065.208.50.0320	SK 50	32	100	72	58	M20X1,5X20	208.00.0200
065.208.50.0400	SK 50	40	115	80	68	M20X1,5X20	208.00.0200
065.208.50.0500	SK 50	50	115	90	78	M24X2X20	208.00.0240



3. MANDRINI a cono ISO MAS 403 BT TOOL HOLDERS with ISO cone MAS 403 BT



Portafrese cilindriche tipo weldon con vite di registrazione interna DIN 6359 B
Milling cutter chucks for straight-shank tools - Weldon System DIN 6359 B
Spannfutter Weldon für Zylinderschäfte DIN 6359 B
Mandrins porte-Weldon pour fraises à queue cylindrique DIN 6359 B

ACCESSORI PER MACCHINE UTENSILI

MAS 403 BT/B



Prebilanciato
Prebalanced
G6.3 / 8000rpm



ART: H208 BT/B

3.
10

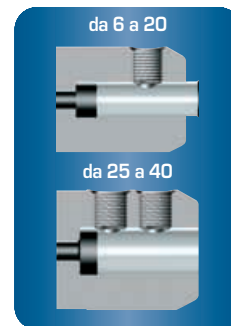
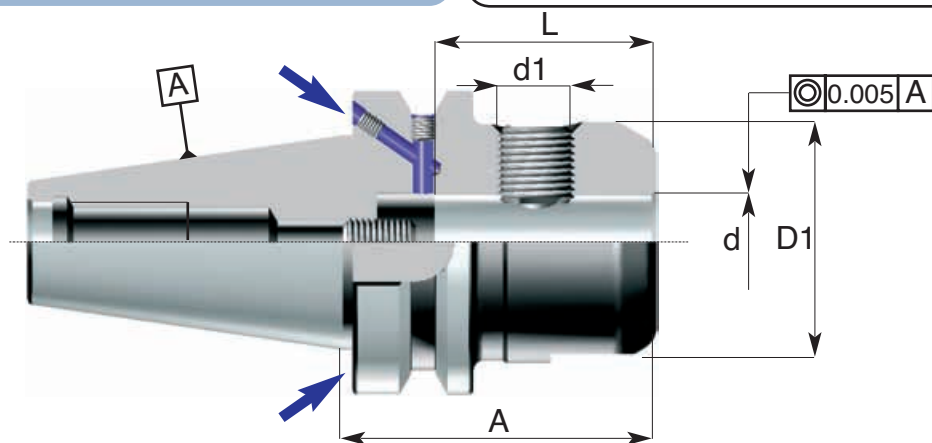

Codice di ord Code	SK	d H5	A	D1	L	d1	Grano di serraggio Clamping screw
H63.208.40.0060	SK 40	6	65	25	35	6MX10	208.00.0060
H63.208.40.0080	SK 40	8	65	28	35	8MX10	208.00.0080
H63.208.40.0100	SK 40	10	65	35	39	10MX12	208.00.0100
H63.208.40.0120	SK 40	12	65	42	44	12MX1,5X16	208.00.0120
H63.208.40.0140	SK 40	14	65	44	44	12MX1,5X16	288.00.0120
H63.208.40.0160	SK 40	16	65	48	47	14MX1,5X16	208.00.0140
H63.208.40.0180	SK 40	18	65	50	47	14MX1,5X16	288.00.0160
H63.208.40.0200	SK 40	20	65	52	49	16MX1,5X16	208.00.0160
H63.208.40.0250	SK 40	25	90	65	54	18MX1,5X20	208.00.0200
H63.208.40.0320	SK 40	32	90	72	58	20MX1,5X20	208.00.0200
H63.208.40.0400	SK 40	40	105	80	68	20MX1,5X20	208.00.0200
H65.208.50.0060	SK 50	6	80	25	35	6MX10	208.00.0060
H65.208.50.0080	SK 50	8	80	28	35	8MX10	208.00.0080
H65.208.50.0100	SK 50	10	80	35	39	10MX12	208.00.0100
H65.208.50.0120	SK 50	12	80	42	44	12MX1,5X16	208.00.0120
H65.208.50.0140	SK 50	14	60	44	44	12MX1,5X16	208.00.0120
H65.208.50.0160	SK 50	16	80	48	47	14MX1,5X16	208.00.0140
H65.208.50.0180	SK 50	16	60	50	47	14MX1,5X16	208.00.0160
H65.208.50.0200	SK 50	20	80	52	49	16MX1,5X16	208.00.0160
H65.208.50.0250	SK 50	25	100	65	54	18MX1,5X20	208.00.0180
H65.208.50.0320	SK 50	32	100	72	58	20MX1,5X20	208.00.0200
H65.208.50.0400	SK 50	40	115	80	68	20MX1,5X20	208.00.0200
H65.208.50.0500	SK 50	50	115	90	78	24MX2X20	208.00.0240



ACCESSORI PER MACCHINE UTENSILI

Portafrese cilindriche tipo weldon con vite di registrazione interna DIN 6359 B
 Milling cutter chucks for straight-shank tools - Weldon System DIN 6359 B
 Spannfutter Weldon für Zylinderschäfte DIN 6359 B
 Mandrins porte-Weldon pour fraises à queue cylindrique DIN 6359 B



Prebilanciato
 Prebalanced
 G6.3 / 8000rpm



MAS 403 BT

ART: 208 BT

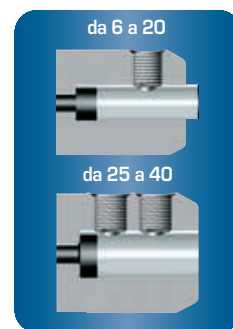
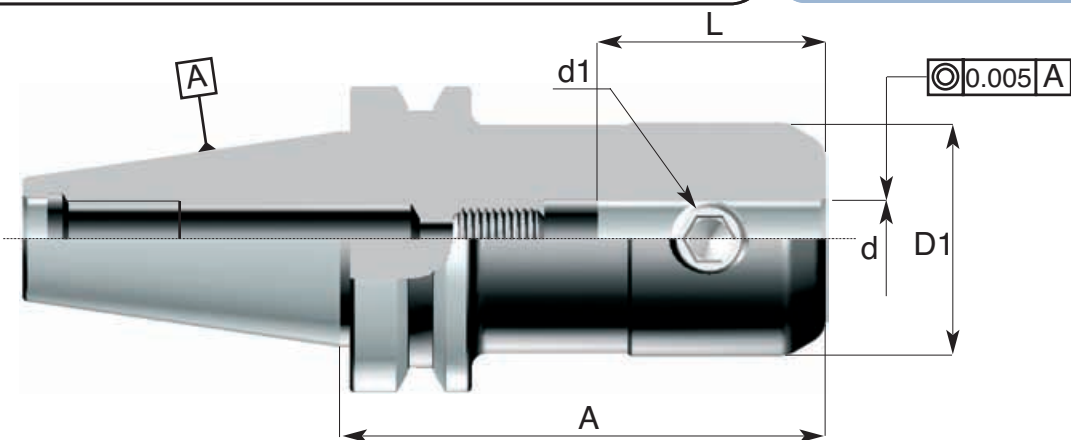

3.
11

Codice di ord Code	SK	d H5	A	D1	L	d1	Grano di serraggio Clamping screw
063.208.40.0062	SK 40	6	100	25	35	M6X10	208.00.0060
063.208.40.0064	SK 40	6	150	25	35	M6X10	208.00.0060
063.208.40.0082	SK 40	8	100	28	35	M8X10	208.00.0080
063.208.40.0084	SK 40	8	150	28	35	M8X10	208.00.0080
063.208.40.0102	SK 40	10	100	35	39	M10X12	208.00.0100
063.208.40.0104	SK 40	10	150	35	39	M10X12	208.00.0100
063.208.40.0122	SK 40	12	100	42	44	M12X1,5X16	208.00.0120
063.208.40.0124	SK 40	12	150	42	44	M12X1,5X16	208.00.0120
063.208.40.0142	SK 40	14	100	44	44	M12X1,5X16	208.00.0120
063.208.40.0144	SK 40	14	150	44	44	M12X1,5X16	208.00.0120
063.208.40.0162	SK 40	16	100	48	47	M14X1,5X16	208.00.0140
063.208.40.0164	SK 40	16	150	48	47	M14X1,5X16	208.00.0140
063.208.40.0182	SK 40	18	100	50	47	M14X1,5X16	208.00.0160
063.208.40.0184	SK 40	18	150	50	47	M14X1,5X16	208.00.0160
063.208.40.0202	SK 40	20	100	52	49	M16X1,5X16	208.00.0180
063.208.40.0204	SK 40	20	150	52	49	M16X1,5X16	208.00.0180
063.208.40.0254	SK 40	25	150	65	54	M18X1,5X20	208.00.0180
063.208.40.0324	SK 40	32	150	72	58	M20X1,5X20	208.00.0200
065.208.50.0062	SK 50	6	100	25	35	M6X10	208.00.0060
065.208.50.0064	SK 50	6	150	25	35	M6X10	208.00.0060
065.208.50.0082	SK 50	8	100	28	35	M8X10	208.00.0080
065.208.50.0084	SK 50	8	150	28	35	M8X10	208.00.0080
065.208.50.0102	SK 50	10	100	35	39	M10X12	208.00.0100
065.208.50.0104	SK 50	10	150	35	39	M10X12	208.00.0100
065.208.50.0122	SK 50	12	100	42	44	M12X1,5X16	208.00.0120
065.208.50.0124	SK 50	12	150	42	44	M12X1,5X16	208.00.0120
063.208.50.0142	SK 50	14	100	44	44	M12X1,5X16	208.00.0120
065.208.50.0144	SK 50	14	150	44	44	M12X1,5X16	208.00.0120
065.208.50.0162	SK 50	16	100	48	47	M14X1,5X16	208.00.0140
065.208.50.0164	SK 50	16	150	48	47	M14X1,5X16	208.00.0140
065.208.50.0182	SK 50	18	100	50	47	M14X1,5X16	208.00.0140
065.208.50.0184	SK 50	18	150	50	47	M14X1,5X16	208.00.0140
065.208.50.0202	SK 50	20	100	52	49	M16X1,5X16	208.00.0160
065.208.50.0204	SK 50	20	150	52	49	M16X1,5X16	208.00.0160
065.208.50.0252	SK 50	25	100	65	54	M18X1,5X20	208.00.0180
065.208.50.0254	SK 50	25	150	65	54	M18X1,5X20	208.00.0180
065.208.50.0324	SK 50	32	150	72	58	M20X1,5X20	208.00.0200
065.208.50.0404	SK 50	40	150	80	68	M20X1,5X20	208.00.0200



3. MANDRINI a cono ISO MAS 403 BT TOOL HOLDERS with ISO cone MAS 403 B



Portafrese cilindriche tipo weldon con vite di registrazione interna DIN 6359 B
Milling cutter chucks for straight-shank tools - Weldon System DIN 6359 B
Spannfutter Weldon für Zylinderschäfte DIN 6359 B
Mandrins porte-Weldon pour fraises à queue cylindrique DIN 6359 B

ACCESSORI PER MACCHINE UTENSILI



MAS 403 BT/B



Prebilanciato
Prebalanced
G6.3 / 8000rpm

ART: 208 BT/B

3.
12

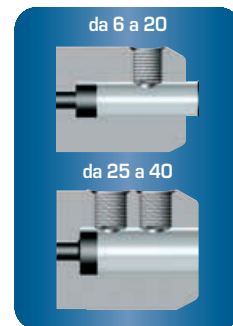
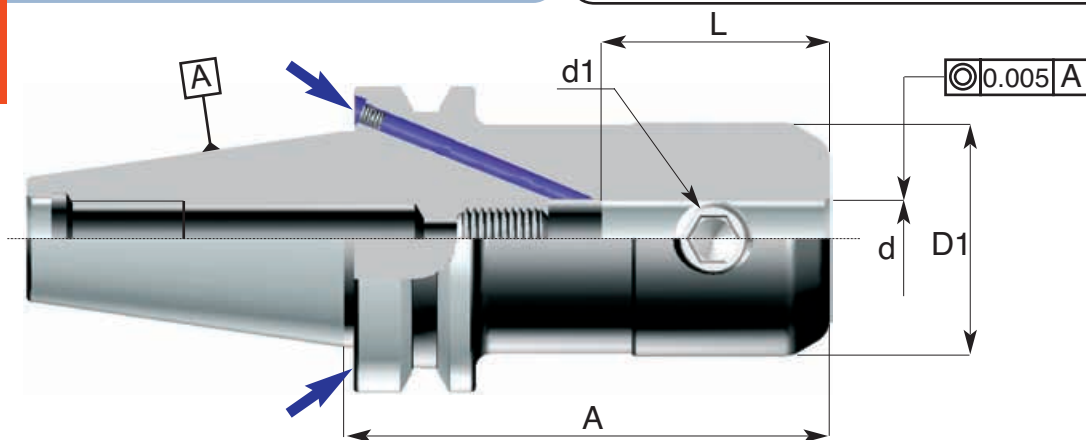

Codice di ord Code	SK	d H5	A	D1	L	d1	Grano di serraggio Clamping screw
H63.208.40.0062	SK 40	6	100	25	35	M6X10	208.00.0060
H63.208.40.0064	SK 40	6	150	25	35	M6X10	208.00.0060
H63.208.40.0082	SK 40	8	100	28	35	M8X10	208.00.0080
H63.208.40.0084	SK 40	8	150	28	35	M8X10	208.00.0080
H63.208.40.0102	SK 40	10	100	35	39	M10X12	208.00.0100
H63.208.40.0104	SK 40	10	150	35	39	M10X12	208.00.0100
H63.208.40.0122	SK 40	12	100	42	44	M12X1,5X16	208.00.0120
H63.208.40.0124	SK 40	12	150	42	44	M12X1,5X16	208.00.0120
H63.208.40.0142	SK 40	14	100	44	44	M12X1,5X16	208.00.0120
H63.208.40.0144	SK 40	14	150	44	44	M12X1,5X16	208.00.0120
H63.208.40.0162	SK 40	16	100	48	47	M14X1,5X16	208.00.0140
H63.208.40.0164	SK 40	16	150	48	47	M14X1,5X16	208.00.0140
H63.208.40.0182	SK 40	18	100	50	47	M14X1,5X16	208.00.0160
H63.208.40.0184	SK 40	18	150	50	47	M14X1,5X16	208.00.0160
H63.208.40.0202	SK 40	20	100	52	49	M16X1,5X16	208.00.0180
H63.208.40.0254	SK 40	25	150	65	54	M18X1,5X20	208.00.0180
H63.208.40.0324	SK 40	32	150	72	58	M20X1,5X20	208.00.0200
H65.208.50.0062	SK 50	6	100	25	35	M6X10	208.00.0060
H65.208.50.0064	SK 50	6	150	25	35	M6X10	208.00.0060
H65.208.50.0082	SK 50	8	100	28	35	M8X10	208.00.0080
H65.208.50.0084	SK 50	8	150	28	35	M8X10	208.00.0080
H65.208.50.0102	SK 50	10	100	35	39	M10X12	208.00.0100
H65.208.50.0104	SK 50	10	150	35	39	M10X12	208.00.0100
H65.208.50.0122	SK 50	12	100	42	44	M12X1,5X16	208.00.0120
H65.208.50.0124	SK 50	12	150	42	44	M12X1,5X16	208.00.0120
H63.208.50.0142	SK 50	14	100	44	44	M12X1,5X16	208.00.0120
H65.208.50.0144	SK 50	14	150	44	44	M12X1,5X16	208.00.0120
H65.208.50.0162	SK 50	16	100	48	47	M14X1,5X16	208.00.0140
H65.208.50.0164	SK 50	16	150	48	47	M14X1,5X16	208.00.0140
H65.208.50.0182	SK 50	18	100	50	47	M14X1,5X16	208.00.0140
H65.208.50.0184	SK 50	18	150	50	47	M14X1,5X16	208.00.0140
H65.208.50.0202	SK 50	20	100	52	49	M16X1,5X16	208.00.0160
H65.208.50.0204	SK 50	20	150	52	49	M16X1,5X16	208.00.0160
H65.208.50.0254	SK 50	25	150	65	54	M18X1,5X20	208.00.0180
H65.208.50.0324	SK 50	32	150	72	58	M20X1,5X20	208.00.0200
H65.208.50.0404	SK 50	40	150	80	68	M20X1,5X20	208.00.0200



ACCESSORI PER MACCHINE UTENSILI

Portafrese per calettamento a caldo secondo DIN 69882-8
 Shrink-fit chucks DIN 69882-8
 Schrumpfutter DIN 69882-8
 Mandrins de frettage DIN 69882-8



Bilanciatura fine
 Fine balancing



MAS 403 BT/B

ART: H206 BT/B

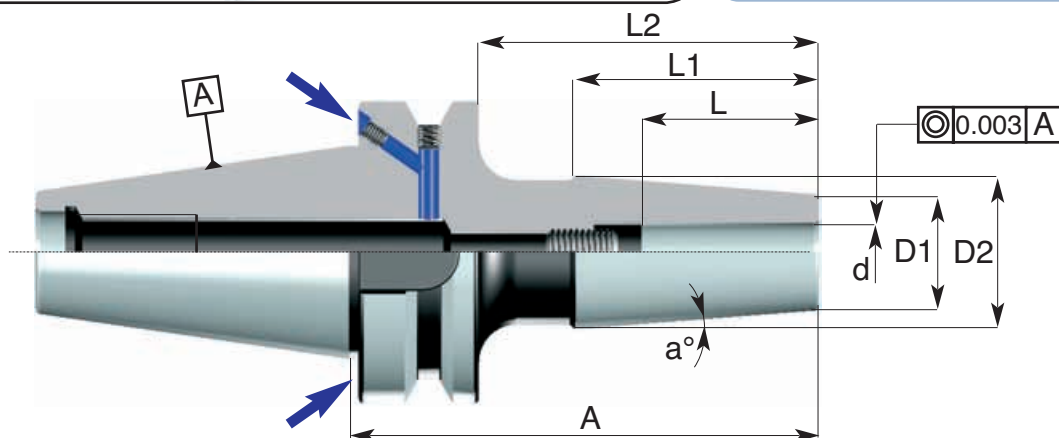

3.
13

Codice di ord Code	SK	d h6	D1	D2	a°	L	L1	L2	A	bilanciatura balancing
H63.206.40.0030	SK 40	3	9	16	4.5°	15	44	54	81	G6.3/2000RPM
H63.206.40.0040	SK 40	4	9	16	4.5°	15	44	54	81	G6.3/2000RPM
H63.206.40.0050	SK 40	5	12	19	4.5°	20	44	54	81	G6.3/2000RPM
H63.206.40.0060	SK 40	6	12	19	4.5°	27	44	64	91	G6.3/1500RPM
H63.206.40.0080	SK 40	8	15	23	4.5°	37	44	64	91	G6.3/1500RPM
H63.206.40.0100	SK 40	10	19	27	4.5°	37	51	66	93	G6.3/1500RPM
H63.206.40.0120	SK 40	12	24	32	4.5°	37	51	71	98	G6.3/1500RPM
H63.206.40.0140	SK 40	14	27	34	4.5°	40	44	71	98	G6.3/1500RPM
H63.206.40.0160	SK 40	16	27	34	4.5°	40	44	71	98	G6.3/1500RPM
H63.206.40.0200	SK 40	20	33	42	4.5°	45	57	81	108	G6.3/1500RPM
H65.206.50.0030	SK 50	3	9	16	4.5°	15	44	54	92	G6.3/2000RPM
H65.206.50.0040	SK 50	4	9	16	4.5°	15	44	54	92	G6.3/2000RPM
H65.206.50.0050	SK 50	5	12	19	4.5°	20	44	54	92	G6.3/2000RPM
H65.206.50.0060	SK 50	6	12	19	4.5°	27	44	64	102	G6.3/1500RPM
H65.206.50.0080	SK 50	8	15	23	4.5°	37	44	64	102	G6.3/1500RPM
H65.206.50.0100	SK 50	10	19	27	4.5°	37	51	66	104	G6.3/1500RPM
H65.206.50.0120	SK 50	12	24	32	4.5°	37	51	71	109	G6.3/1500RPM
H65.206.50.0140	SK 50	14	27	34	4.5°	40	44	71	109	G6.3/1500RPM
H65.206.50.0160	SK 50	16	27	34	4.5°	40	44	71	109	G6.3/1500RPM
H65.206.50.0200	SK 50	20	33	42	4.5°	45	57	81	119	G6.3/1500RPM

3. MANDRINI a cono ISO MAS 403 BT

TOOL HOLDERS with ISO cone MAS 403 BT



Portafrese per calettamento a caldo secondo DIN 69882-8
 Shrink-fit chucks DIN 69882-8
 Schrumpfutter DIN 69882-8
 Mandrins de frettage DIN 69882-8

ACCESSORI PER MACCHINE UTENSILI

MAS 403 BT/B



Bilanciatura fine
 Fine balancing



ART: H206 BT/B

3.
14

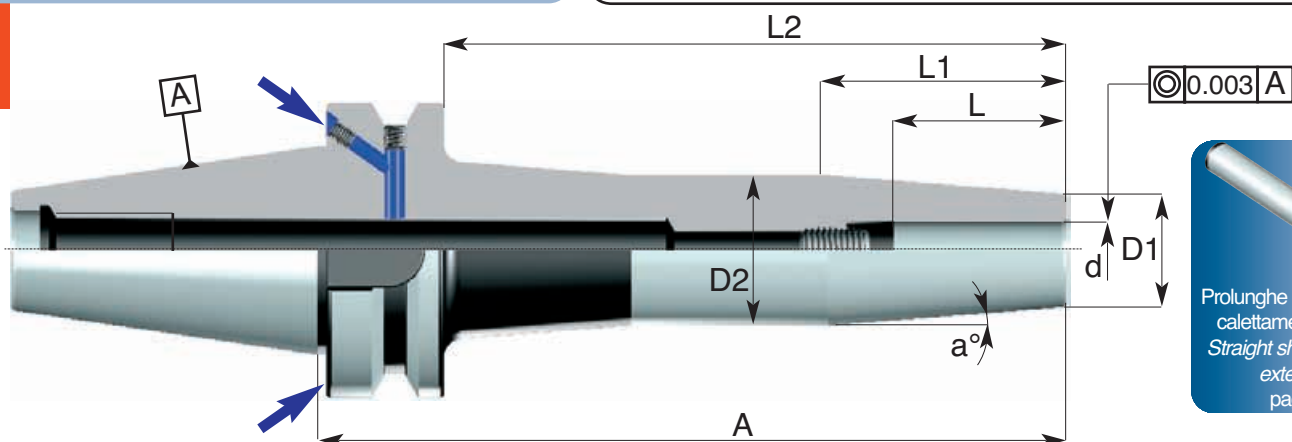

Prolunghe cilindriche per calettamento a caldo
 Straight shank shrink-fit extensions
 pag: 9.4

Codice di ord Code	SK	d h6	D1	D2	a°	L	L1	L2	A	bilanciatura balancing
H63.206.40.0062	SK 40	6	12	22	4.5°	24	64	133	160	G6.3/2000ORPM
H63.206.40.0082	SK 40	8	15	23	4.5°	34	50	133	160	G6.3/2000ORPM
H63.206.40.0102	SK 40	10	19	27	4.5°	37	51	133	160	G6.3/2000ORPM
H63.206.40.0122	SK 40	12	24	32	4.5°	37	51	133	160	G6.3/2000ORPM
H63.206.40.0162	SK 40	16	27	34	4.5°	40	44	133	160	G6.3/2000ORPM
H63.206.40.0202	SK 40	20	33	42	4.5°	45	57	133	160	G6.3/2000ORPM
H65.206.50.0032	SK 50	3	9	16	4.5°	15	44	122	160	G6.3/1500ORPM
H65.206.50.0042	SK 50	4	9	16	4.5°	15	44	122	160	G6.3/1500ORPM
H65.206.50.0052	SK 50	5	12	19	4.5°	20	44	122	160	G6.3/1500ORPM
H65.206.50.0062	SK 50	6	12	22	4.5°	27	63	122	160	G6.3/1500ORPM
H65.206.50.0082	SK 50	8	15	23	4.5°	34	50	122	160	G6.3/1500ORPM
H65.206.50.0102	SK 50	10	19	27	4.5°	37	50	122	160	G6.3/1500ORPM
H65.206.50.0122	SK 50	12	24	32	4.5°	37	51	122	160	G6.3/1500ORPM
H65.206.50.0142	SK 50	14	27	34	4.5°	40	44	122	160	G6.3/1500ORPM
H65.206.50.0162	SK 50	16	27	34	4.5°	40	44	122	160	G6.3/1500ORPM
H65.206.50.0202	SK 50	20	33	42	4.5°	45	57	122	160	G6.3/1500ORPM
H65.206.50.0252	SK 50	25	44	53	4.5°	48	57	122	160	G6.3/1500ORPM
H65.206.50.0322	SK 50	32	44	53	4.5°	48	57	122	160	G6.3/1500ORPM

FUORI PRODUZIONE



Bilanciatura fine
Fine balancing



MAS 403 BT/B

ART: H63.207 BT/B

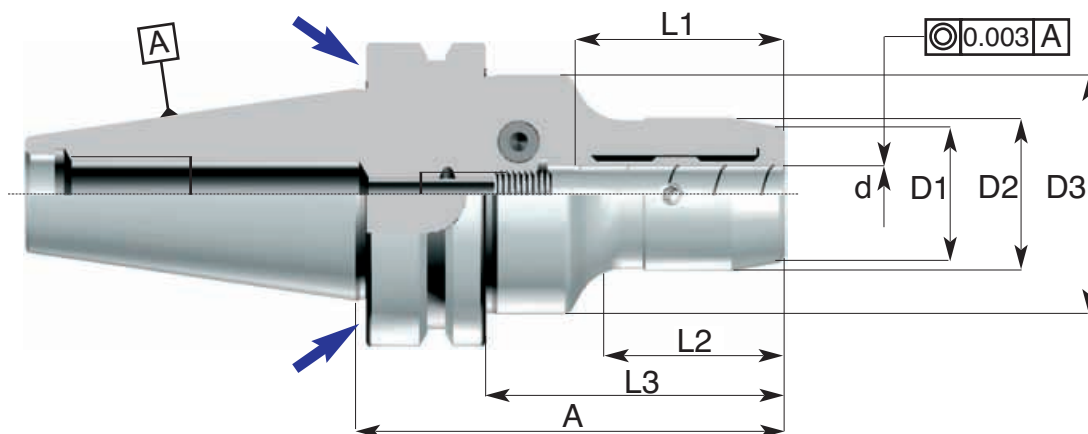

3.
15



Codice di ord Code	SK	d	D1	D2	D3	L1	L2	L3	A	bilanciatura balancing
H63.207.40.0060	SK 40	6	22	26	50	35	38	63	90	G6.3/15000RPM
H63.207.40.0080	SK 40	8	24	28	50	35	38	63	90	G6.3/15000RPM
H63.207.40.0100	SK 40	10	26	30	50	35	38	63	90	G6.3/15000RPM
H63.207.40.0120	SK 40	12	28	32	50	44	40	63	90	G6.3/15000RPM
H63.207.40.0140	SK 40	14	30	34	50	44	40	63	90	G6.3/15000RPM
H63.207.40.0160	SK 40	16	34	38	50	47	47	65	92	G6.3/15000RPM
H63.207.40.0200	SK 40	20	38	42	50	49	47	65	92	G6.3/15000RPM
H65.207.50.0060	SK 50	6	22	26	50	35	38	63	101	G6.3/15000RPM
H65.207.50.0080	SK 50	8	24	28	50	35	38	63	101	G6.3/15000RPM
H65.207.50.0100	SK 50	10	26	30	50	35	38	63	101	G6.3/15000RPM
H65.207.50.0120	SK 50	12	28	32	50	44	40	63	101	G6.3/15000RPM
H65.207.50.0140	SK 50	14	30	34	50	44	40	63	101	G6.3/15000RPM
H65.207.50.0160	SK 50	16	34	38	50	47	47	65	103	G6.3/15000RPM
H65.207.50.0200	SK 50	20	38	42	50	49	47	65	103	G6.3/15000RPM
H65.207.50.0250	SK 50	25	46	50	70	54	55	80	118	G6.3/15000RPM
H65.207.50.0320	SK 50	32	52	58	70	58	62	85	123	G6.3/15000RPM

3. MANDRINI a cono ISO MAS 403 BT TOOL HOLDERS with ISO cone MAS 403 BT



Mandriani a chiusura idraulica HYDRO-DELTA

Hydraulic clamping chucks HYDRO DELTA

Dehnspannfutter HYDRO DELTA

Mandriins expansibles HYDRO DELTA

ACCESSORI PER MACCHINE UTENSILI

FUORI PRODUZIONE

MAS 403 BT/B



Bilanciatura fine
Fine balancing



ART: H63.207 BT/B

3.
16

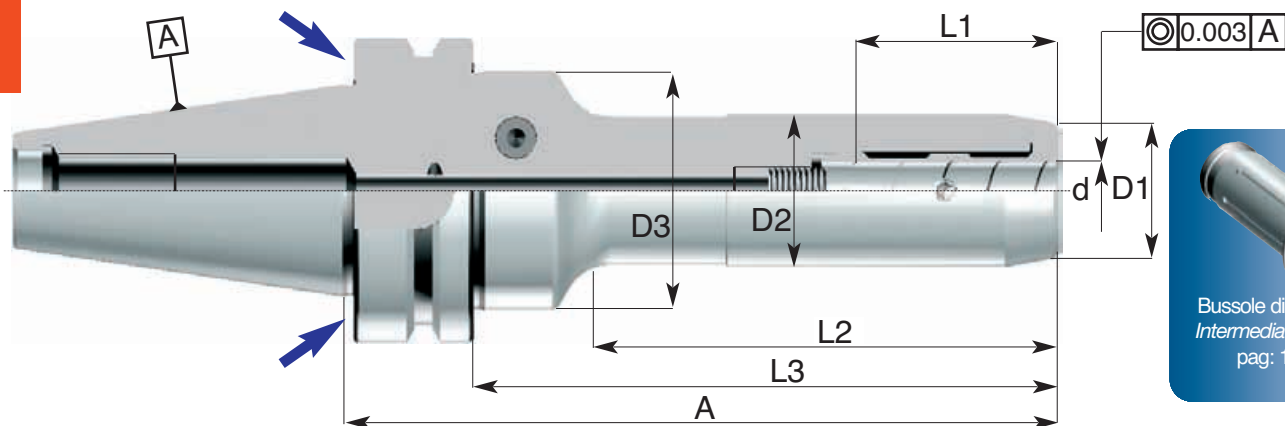

Codice di ord Code	SK	d	D1	D2	D3	L1	L2	L3	A	bilanciatura balancing
H63.207.40.0062	SK 40	6	22	26	50	35	98	123	150	G6.3/15000RPM
H63.207.40.0064	SK 40	6	22	26	50	35	148	173	200	G6.3/15000RPM
H63.207.40.0082	SK 40	8	24	28	50	35	98	123	150	G6.3/15000RPM
H63.207.40.0084	SK 40	8	24	28	50	35	148	173	200	G6.3/15000RPM
H63.207.40.0102	SK 40	10	26	30	50	35	98	123	150	G6.3/15000RPM
H63.207.40.0104	SK 40	10	26	30	50	35	148	173	200	G6.3/15000RPM
H63.207.40.0122	SK 40	12	28	32	50	44	98	123	150	G6.3/15000RPM
H63.207.40.0124	SK 40	12	28	32	50	44	148	173	200	G6.3/15000RPM
H63.207.40.0142	SK 40	14	30	34	50	44	98	123	150	G6.3/15000RPM
H63.207.40.0144	SK 40	14	30	34	50	44	148	173	200	G6.3/15000RPM
H63.207.40.0162	SK 40	16	34	38	50	47	98	123	150	G6.3/15000RPM
H63.207.40.0164	SK 40	16	34	38	50	47	148	173	200	G6.3/15000RPM
H63.207.40.0202	SK 40	20	38	42	50	47	98	123	150	G6.3/15000RPM
H63.207.40.0204	SK 40	20	38	42	50	47	148	173	200	G6.3/15000RPM
H65.207.50.0062	SK 50	6	22	26	50	35	87	112	150	G6.3/15000RPM
H65.207.50.0064	SK 50	6	22	26	50	35	137	162	200	G6.3/15000RPM
H65.207.50.0082	SK 50	8	24	28	50	35	87	112	150	G6.3/15000RPM
H65.207.50.0084	SK 50	8	24	28	50	35	137	162	200	G6.3/15000RPM
H65.207.50.0102	SK 50	10	26	30	50	35	87	112	150	G6.3/15000RPM
H65.207.50.0104	SK 50	10	26	30	50	35	137	162	200	G6.3/15000RPM
H65.207.50.0122	SK 50	12	28	32	50	44	87	112	150	G6.3/15000RPM
H65.207.50.0124	SK 50	12	28	32	50	44	137	162	200	G6.3/15000RPM
H65.207.50.0142	SK 50	14	30	34	50	44	87	112	150	G6.3/15000RPM
H65.207.50.0144	SK 50	14	30	34	50	44	137	162	200	G6.3/15000RPM
H65.207.50.0162	SK 50	16	34	38	50	47	87	112	150	G6.3/15000RPM
H65.207.50.0164	SK 50	16	34	38	50	47	137	162	200	G6.3/15000RPM
H65.207.50.0202	SK 50	20	38	42	50	47	87	112	150	G6.3/15000RPM
H65.207.50.0204	SK 50	20	38	42	50	47	137	162	200	G6.3/15000RPM
H65.207.50.0252	SK 50	25	46	50	70	54	87	112	150	G6.3/15000RPM
H65.207.50.0254	SK 50	25	46	50	70	54	137	162	200	G6.3/15000RPM
H65.207.50.0322	SK 50	32	52	58	70	58	87	112	150	G6.3/15000RPM
H65.207.50.0324	SK 50	32	52	58	70	58	137	162	200	G6.3/15000RPM

ACCESSORI PER MACCHINE UTENSILI

Mandrini portatestine filetate
 Chucks for threaded heads
 Mandrins pour têtes filetées
 Spannfutter für Gewindeköpfe



Bilanciatura fine
 Fine balancing



MAS 403 BT

ART: 267 BT

3.
17

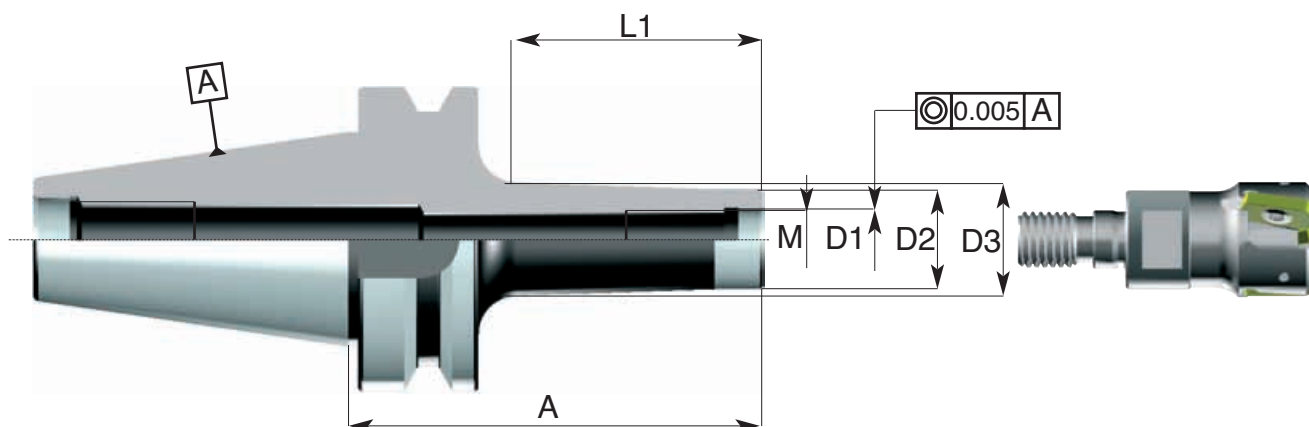

Codice di ord Code	SK	M	D1	D2	D3	L1	A	bilanciatura balancing
063.267.40.0062	SK 40	M6	6.5	9.7	20	51	86	G6.3/15000RPM
063.267.40.0064	SK 40	M6	6.5	9.7	23	71	106	G6.3/15000RPM
063.267.40.0082	SK 40	M8	8.5	12.7	23	51	86	G6.3/15000RPM
063.267.40.0084	SK 40	M8	8.5	12.7	23	71	106	G6.3/15000RPM
063.267.40.0100	SK 40	M10	10.5	17.7	20	31	66	G6.3/15000RPM
063.267.40.0102	SK 40	M10	10.5	17.7	25	51	86	G6.3/15000RPM
063.267.40.0104	SK 40	M10	10.5	17.7	28	71	106	G6.3/15000RPM
063.267.40.0106	SK 40	M10	10.5	17.7	28	91	126	G6.3/15000RPM
063.267.40.0120	SK 40	M12	12.5	20.7	24	31	66	G6.3/15000RPM
063.267.40.0122	SK 40	M12	12.5	20.7	24	51	86	G6.3/15000RPM
063.267.40.0124	SK 40	M12	12.5	20.7	31	71	106	G6.3/15000RPM
063.267.40.0126	SK 40	M12	12.5	20.7	31	91	126	G6.3/15000RPM
063.267.40.0160	SK 40	M16	17	28.7	34	31	66	G6.3/15000RPM
063.267.40.0162	SK 40	M16	17	28.7	34	51	86	G6.3/15000RPM
063.267.40.0164	SK 40	M16	17	28.7	34	71	106	G6.3/15000RPM
063.267.40.0166	SK 40	M16	17	28.7	34	91	126	G6.3/15000RPM
063.267.40.0168	SK 40	M16	17	28.7	34	150	185	G6.3/15000RPM
063.267.40.0169	SK 40	M16	17	28.7	34	200	235	G6.3/15000RPM

3. MANDRINI a cono ISO MAS 403 BT

TOOL HOLDERS with ISO cone MAS 403 BT



Mandrini portatestine filettate
Chucks for threaded heads
Mandrins pour têtes filetées
Spannfutter für Gewindeköpfe

ACCESSORI PER MACCHINE UTENSILI



MAS 403 BT



Bilanciatura fine
Fine balancing

ART: 267 BT

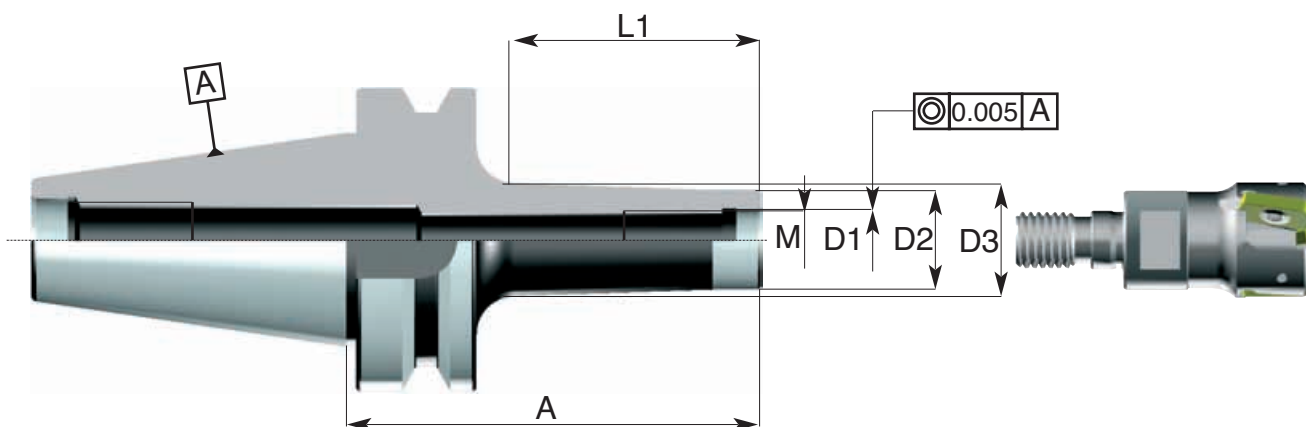

Codice di ord Code	SK	M	D1	D2	D3	L1	A	bilanciatura balancing
065.267.50.0100	SK 50	M10	10.5	17.7	20	31	77	G6.3/15000RPM
065.267.50.0102	SK 50	M10	10.5	17.7	25	51	97	G6.3/15000RPM
065.267.50.0104	SK 50	M10	10.5	17.7	28	71	117	G6.3/15000RPM
065.267.50.0106	SK 50	M10	10.5	17.7	31	100	146	G6.3/15000RPM
065.267.50.0120	SK 50	M12	12.5	20.7	24	31	77	G6.3/15000RPM
065.267.50.0122	SK 50	M12	12.5	20.7	24	51	97	G6.3/15000RPM
065.267.50.0124	SK 50	M12	12.5	20.7	31	71	117	G6.3/15000RPM
065.267.50.0126	SK 50	M12	12.5	20.7	31	101	147	G6.3/15000RPM
065.267.50.0128	SK 50	M12	12.5	20.7	41	150	196	G6.3/15000RPM
065.267.50.0160	SK 50	M16	17	28.7	29	31	77	G6.3/15000RPM
065.267.50.0162	SK 50	M16	17	28.7	34	51	97	G6.3/15000RPM
065.267.50.0164	SK 50	M16	17	28.7	34	71	117	G6.3/15000RPM
065.267.50.0166	SK 50	M16	17	28.7	41	100	146	G6.3/15000RPM
065.267.50.0168	SK 50	M16	17	28.7	52	150	196	G6.3/15000RPM
065.267.50.0169	SK 50	M16	17	28.7	57	200	246	G6.3/15000RPM

ACCESSORI PER MACCHINE UTENSILI



Mandriani portamorsetti autoserranti DIN 238
 Taper shafts for drill chucks DIN 238
 Bohrfutteraufnahmen DIN 238
 Porte-mandrins de perceuses DIN 238



MAS 403 BT

ART: 220 BT

3.
19

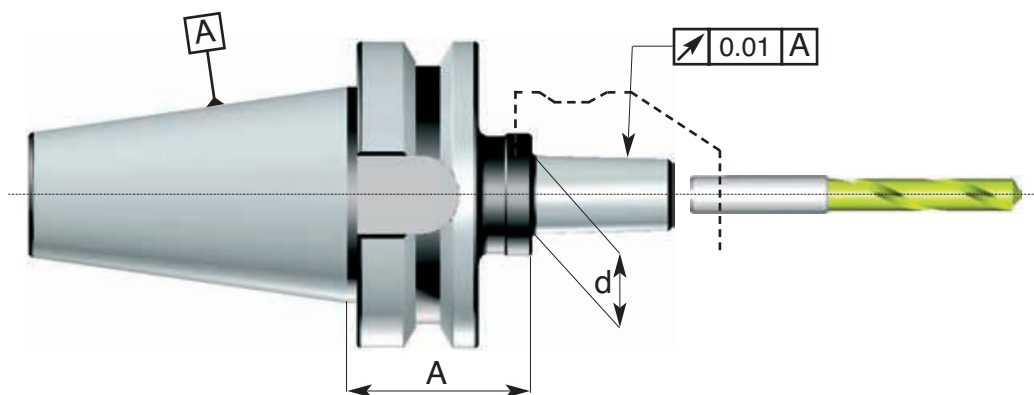

Codice di ord Code	SK	Tipo Din	A	d
060.220.30.0120	SK 30	B 12	35	12.065
060.220.30.0160	SK 30	B 16	35	15.733
061.220.35.0120	SK 35	B 12	35	12.065
061.220.35.0160	SK 35	B 16	35	15.733
063.220.40.0120	SK 40	B 12	50	12.065
063.220.40.0160	SK 40	B 16	50	15.733
063.220.40.0180	SK 40	B 18	50	17.780
065.220.50.0160	SK 50	B 16	70	15.733
065.220.50.0180	SK 50	B 18	70	17.780

3. MANDRINI a cono ISO MAS 403 BT

TOOL HOLDERS with ISO cone MAS 403 BT



Mandrini portapunte integrali
 Integral drill chucks
 Kurzbohrfutter
 Mandrins porte-forets intégraux

ACCESSORI PER MACCHINE UTENSILI

MAS 403 BT



ART: 221 BT

3.
20

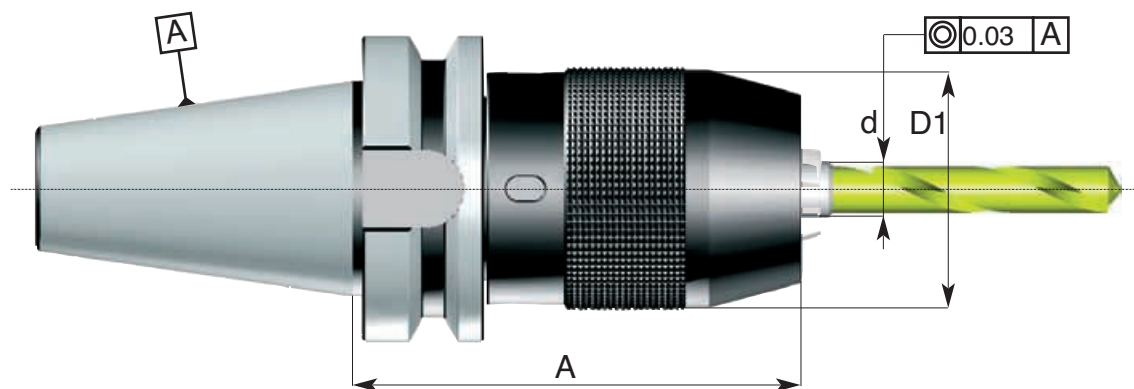

Codice di ord Code	SK	A	D	capacità "d" Capacity range "d"
063.221.40.1301	SK 40	95	50	1-13
063.221.40.1603	SK 40	100	57	3-16
065.221.50.1301	SK 50	105	50	1-13
065.221.50.1603	SK 50	108	57	3-16

ADATTI SOLO A ROTAZIONE DESTRA
 SUITABLE FOR RIGHT ROTATION ONLY

Forniti completi di chiave
 Supplied together with key

ACCESSORI PER MACCHINE UTENSILI



Riduzioni da cono BT a cono ISO DIN 2080 e DIN 69871
 Adaptors sleeves BT to ISO cone DIN 2080 and DIN 69871
 Zwischenhülsen BT zu ISO Steilkegel DIN 2080 und DIN 69871
 Douilles de réduction cône BT à ISO DIN 2080 et DIN 69871



MAS 403 BT

ART: 250 BT

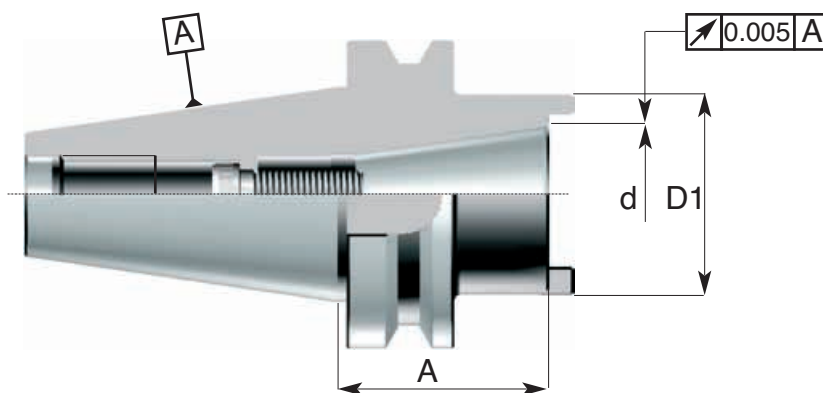
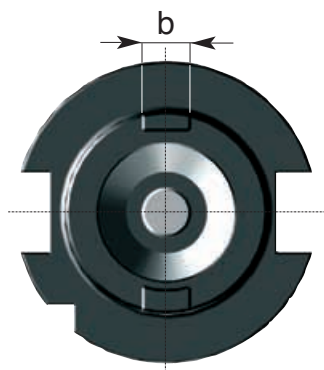

3.
21

Codice di ord Code	BT	SK	d	A	D1	b	Vite Screw	Ghiera Nut
063.250.40.0300	SK 40	SK 30	31,75	50	52	15,9	252.00.1230.B	252.00.1810
065.250.50.0300	SK 50	SK 30	31,75	50	52	15,9	252.00.1230	261.24.0400
065.250.50.0400	SK 50	SK 40	44,45	70	70	15,9	252.00.1640.B	261.24.0400
065.250.50.0450	SK 50	SK 45	57,17	100	80	19	252.00.2050.B	252.00.3013

per DIN 69871 specificare nell'ordine la vite
 for DIN 69871 specify the screw code in the order



Codice di ord Code	Vite per DIN 69871 Screw for DIN 69871
063.250.40.0300	252.00.1250.B
065.250.50.0300	252.00.1250
065.250.50.0400	252.00.1670.B
065.250.50.0450	252.00.2080.B



3. MANDRINI a cono ISO MAS 403 BT TOOL HOLDERS with ISO cone MAS 403 BT



Riduzioni da cono ISO a cono ISO naso mandrino DIN 2079

Adaptors sleeves ISO to ISO cone with DIN 2079 spindle nose
Zwischenhülsen ISO zu ISO Steilkegel mit DIN 2079 Spindelkopf
Douilles de réduction cône ISO à cône ISO avec nez de broche DIN 2079

ACCESSORI PER MACCHINE UTENSILI

MAS 403 BT



ART:252 BT

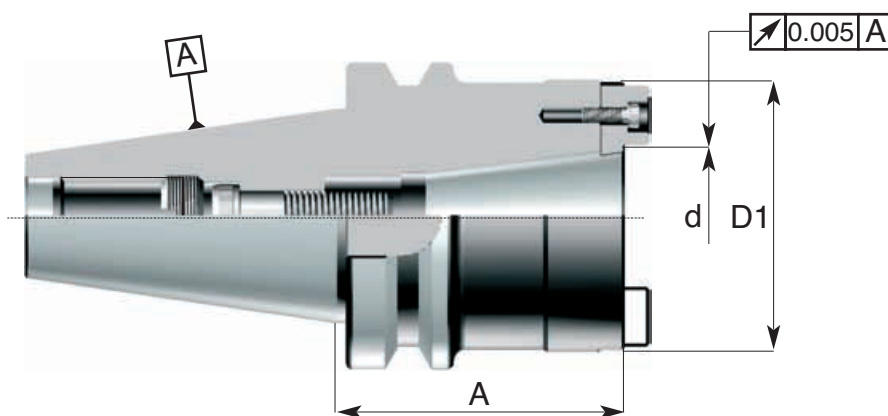
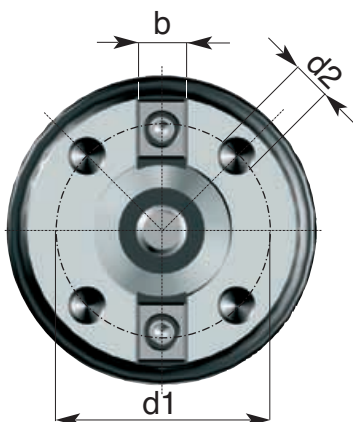

Codice di ord Code	BT	SK	A	D1 h6	d1	d2	b	Tassello Tenon	Vite Screw	Ghiera Nut
063.252.40.0300	SK 40	SK 30	55	69.832	54	M10	15.9	192.01	252.00.1245.B	252.00.1230
065.252.50.0400	SK 50	SK 40	75	88.882	66.70	M12	15.9	192.02	252.00.1640.B	261.24.0400
065.252.50.0450	SK 50	SK 45	90	101.60	80.00	M12	19	192.45.0190	252.00.2050	252.00.3013



Pag. 12/26

3.
22

ACCESSORI PER MACCHINE UTENSILI



Riduzioni da cono ISO a cono Morse DIN 6364 B per frese con vite interna
 Morse taper adaptors sleeves for cutters with internal screw - DIN 6364 B
 Zwischenhülsen für Morsekegel mit Auzugsgewinde - DIN 6364 B
 Douilles de réduction à cône Morse pour fraises avec vis - DIN 6364 B



MAS 403 BT

ART: 261 BT

3.
23

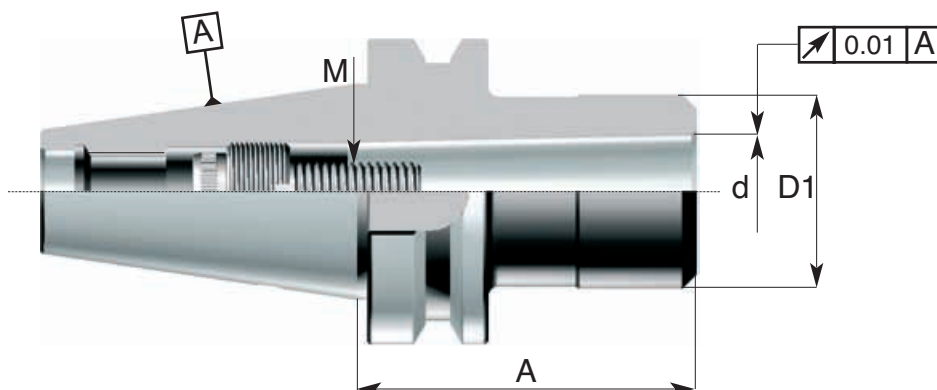

Codice di ord Code	SK	Cono Morse	d	A	D1	M	Vite Screw	Ghiera Nut
063.261.40.0100	SK 40	Morse 1	12.065	40	25	6M	261.00.0625	261.16.0100
063.261.40.0200	SK 40	Morse 2	17.780	50	32	10M	261.00.1030.B	261.16.0200
063.261.40.0300	SK 40	Morse 3	23.825	70	40	12M	261.00.1240	261.00.1220
063.261.40.0400	SK 40	Morse 4	31.267	95	50	16M	261.00.1650.E	261.00.1626
065.261.50.0100	SK 50	Morse 1	12.065	50	25	6M	261.00.0645	261.24.0100
065.261.50.0200	SK 50	Morse 2	17.780	50	32	10M	261.00.1040	261.24.0200
065.261.50.0300	SK 50	Morse 3	23.825	60	40	12M	261.00.1240	261.24.0300
065.261.50.0400	SK 50	Morse 4	31.267	80	50	16M	261.00.1645B	261.24.0400
065.261.50.0500	SK 50	Morse 5	44.399	100	65	20M	261.00.2050	261.00.2033



3. MANDRINI a cono ISO MAS 403 BT

TOOL HOLDERS with ISO cone MAS 403 BT



Riduzioni da cono ISO a cono Morse per punte tipo normale e prolungato

Adaptors sleeves from ISO cone to Morse cone for tools with driving shank

Zwischenhülsen mit Steilkegel für Werkzeuge mit Morsekegel und Ausstreiblappen

Douilles de réduction de cône ISO à cône Morse pour outils munies de dents d'entraînement

ACCESSORI PER MACCHINE UTENSILI

MAS 403 BT



ART: 262 BT



3.
24

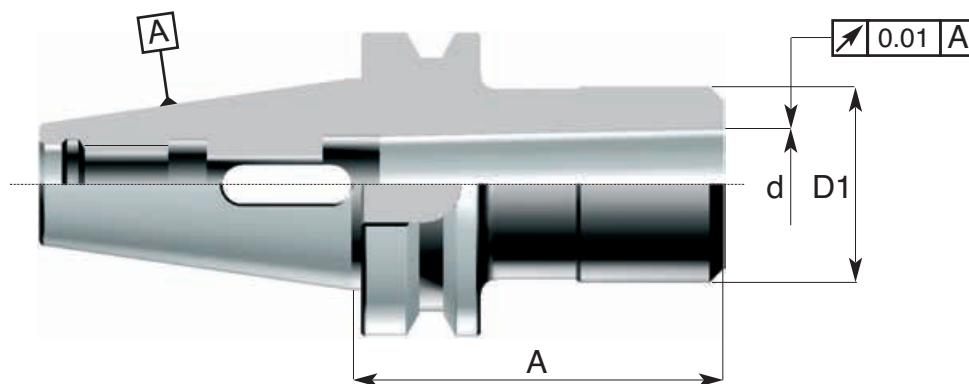

Codice di ord Code	SK	Cono Morse	d	A	D1	Combi*
060.262.30.0100	SK 30	Morse 1	12.065	50	25	PF
060.262.30.0200	SK 30	Morse 2	17.780	60	30	-
060.262.30.0300	SK 30	Morse 3	23.825	75	40	-
063.262.40.0100	SK 40	Morse 1	12.065	45	25	PF
063.262.40.0102	SK 40	Morse 1	12.065	120	25	PF
063.262.40.0200	SK 40	Morse 2	17.780	50	32	PF
063.262.40.0202	SK 40	Morse 2	17.780	135	32	PF
063.262.40.0300	SK 40	Morse 3	23.825	70	40	PF
063.262.40.0302	SK 40	Morse 3	23.825	150	40	-
063.262.40.0400	SK 40	Morse 4	31.267	90	50	-
063.262.40.0402	SK 40	Morse 4	31.267	165	50	-
065.262.50.0100	SK 50	Morse 1	12.065	45	25	PF
065.262.50.0102	SK 50	Morse 1	12.065	120	25	PF
065.262.50.0200	SK 50	Morse 2	17.780	50	32	PF
065.262.50.0202	SK 50	Morse 2	17.780	135	32	PF
065.262.50.0300	SK 50	Morse 3	23.825	63	40	PF
065.262.50.0302	SK 50	Morse 3	23.825	150	40	PF
065.262.50.0304	SK 50	Morse 3	23.825	180	40	PF
065.262.50.0400	SK 50	Morse 4	31.267	75	50	PF
065.262.50.0402	SK 50	Morse 4	31.267	180	50	PF
065.262.50.0500	SK 50	Morse 5	44.399	105	70	-

*Le riduzioni PF sono adatte anche per frese con attacco DIN 228-A; per i tipi ISO 30 CM2-3, ISO 40 CM3-4, ISO 45 CM5 e ISO 50 CM5 è necessario l'uso del tirante lungo (vedi sezione tiranti)

*PF adaptors are suitable for clamping MT-shank mills; for ISO 30 MK2-3, ISO 40 MK3-4, ISO 45 MK5 e ISO 50 MK5 long pull stud is required (see pull studs section)

ACCESSORI PER MACCHINE UTENSILI

Riduzioni da cono ISO a cono Morse per punte

Morse taper adaptors sleeves for drills with driving shank

Zwischenhülsen für Morsekegel mit Austreibklappen

Douilles de réduction à cône Morse pour forets avec dents d'entraînement



FUORI PRODUZIONE



MAS 403 BT/B

ART: H262 BT/B

3.
25

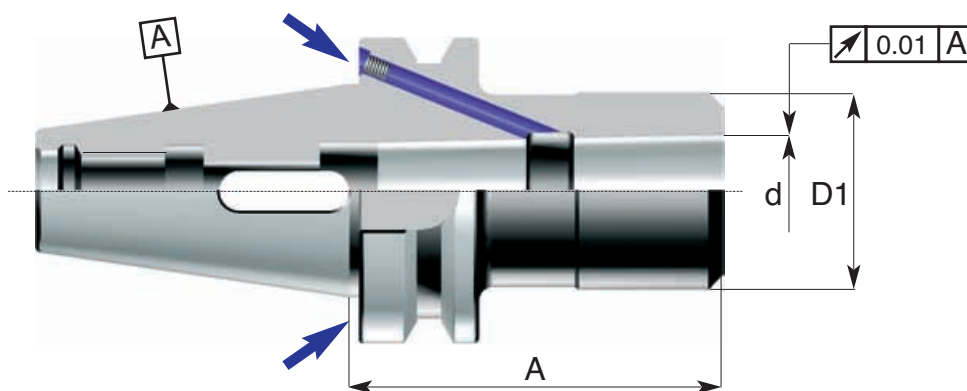

Codice di ord Code	SK	Cono Morse	d	A	D1	Combi*
H63.262.40.0100	SK 40	Morse 1	12.065	45	25	PF
H63.262.40.0200	SK 40	Morse 2	17.780	50	32	PF
H63.262.40.0300	SK 40	Morse 3	23.825	70	40	PF
H63.262.40.0400	SK 40	Morse 4	31.267	90	50	PF
H65.262.50.0100	SK 50	Morse 1	12.065	45	25	PF
H65.262.50.0200	SK 50	Morse 2	17.780	50	32	PF
H65.262.50.0300	SK 50	Morse 3	23.825	63	40	PF
H65.262.50.0400	SK 50	Morse 4	31.267	75	50	PF
H65.262.50.0500	SK 50	Morse 5	44.399	105	70	PF

*Le riduzioni PF sono adatte anche per frese con attacco DIN 228-A; per i tipi ISO 30 CM2-3, ISO 40 CM3-4, ISO 45 CM5 e ISO 50 CM5 è necessario l'uso del tirante lungo (vedi sezione tiranti)

*PF adaptors are suitable for clamping mills with MT-shank; for ISO 30 MK2-3, ISO 40 MK3-4, ISO 45 MK5 e ISO 50 MK5 is necessary the long pull stud (see pull studs section)

3. MANDRINI a cono ISO MAS 403 BT

TOOL HOLDERS with ISO cone MAS 403 BT



Barre semifinite con tratto cilindrico privo di cementazione per esecuzioni speciali
 Unfinished taper-shank blanks for special applications
 Rohlinge für spezielle Anwendungen
 Ebauches pour applications spéciales

ACCESSORI PER MACCHINE UTENSILI



MAS 403 BT



ART: 424 BT

3.
26

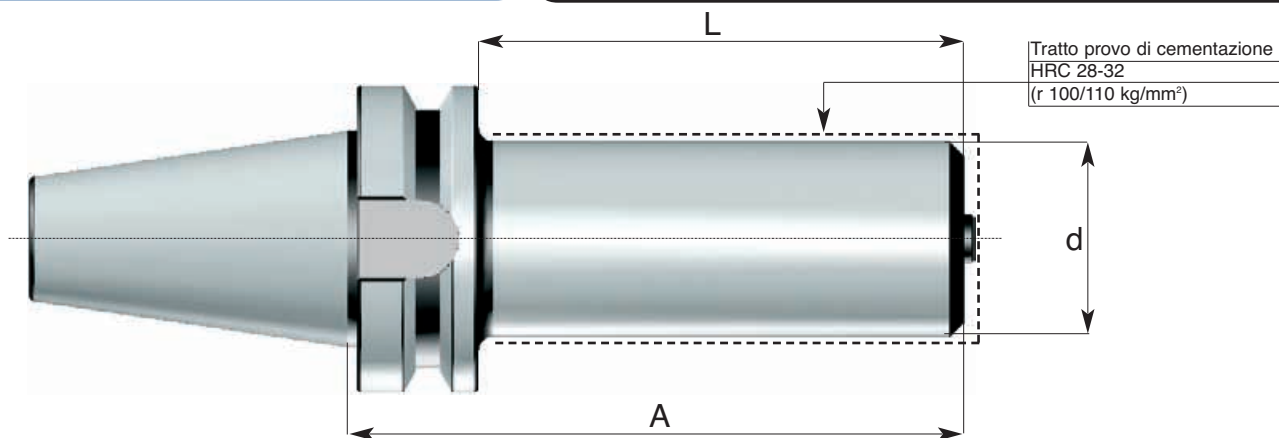

Codice di ord Code	SK	d	A	L
063.424.40.0402	SK 40	40	197	170
063.424.40.0404	SK 40	40	277	250
063.424.40.0630	SK 40	63	177	150
063.424.40.0632	SK 40	63	277	250
065.424.50.0502	SK 50	50	247	210
065.424.50.0504	SK 50	50	352	315
065.424.50.0630	SK 50	63	188	150
065.424.50.0632	SK 50	63	288	250
065.424.50.0634	SK 50	63	438	400
065.424.50.1000	SK 50	100	288	250
065.424.50.1002	SK 50	100	438	400

ACCESSORI PER MACCHINE UTENSILI

Mandrini a forte serraggio
 High clamping chucks
 Kraftspannfutter
 Mandrins à fort serrage

FUORI PRODUZIONE



Prebilanciato
 Prebalanced
 G6.3 / 8000rpm



MAS 403 BT

ART: 603.BT
 standard / standard lenght

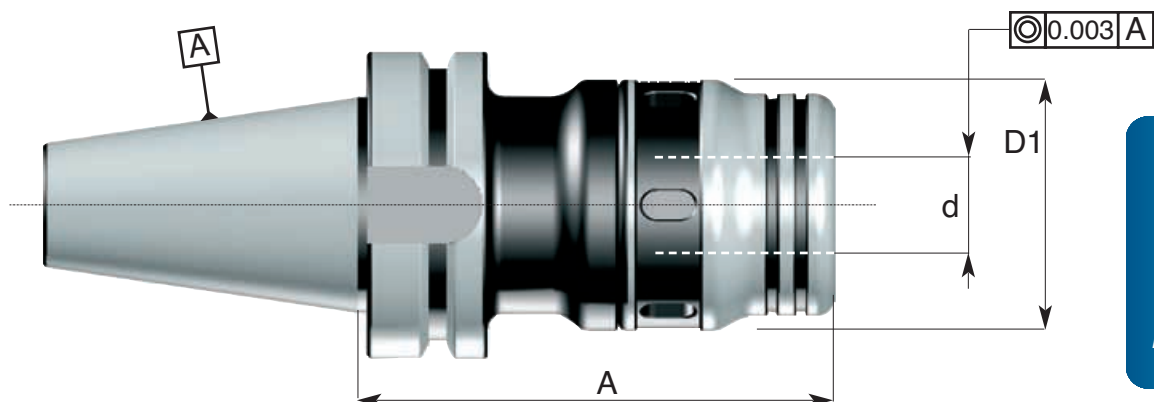

3.
27



Codice di ord Code	SK	d	D1	A	Boccola di riduzione Reduction bushes
063.603.40.0200	SK 40	20	54	105	239.20...
063.603.40.0320	SK 40	32	72	105	239.32...
063.603.40.0322	SK 40	32	72	135	239.32...
065.603.50.0200	SK 50	20	54	105	239.20...
065.603.50.0320	SK 50	32	72	105	239.32...
065.603.50.0322	SK 50	32	72	135	239.32...

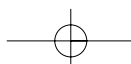

3. MANDRINI a cono ISO MAS 403 BT

TOOL HOLDERS with ISO cone MAS 403 BT



Mandrini portapinzine EOC tipo normale e prolungato DIN 6388

Collet chucks EOC - DIN 6388

Spannzangenhalter EOC - DIN 6388

Mandrins porte-pinces EOC - DIN 6388

ACCESSORI PER MACCHINE UTENSILI

MAS 403 BT



ART:601 BT

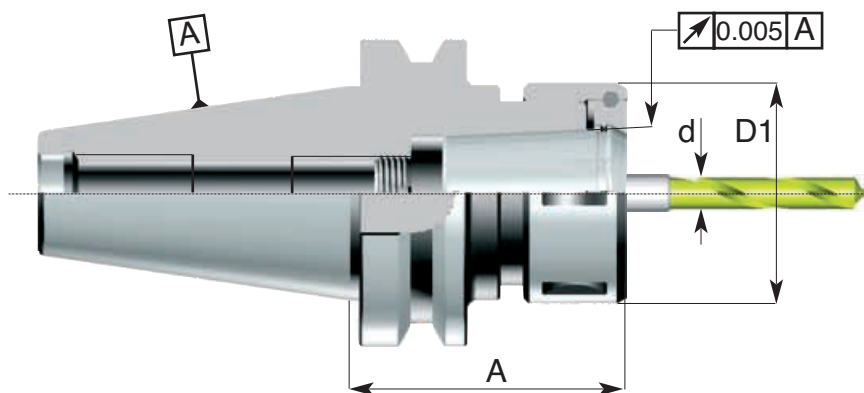

Pinze / Collets
pag: 12.4

Ghiere / Nuts
pag: 12.14

Codice di ord Code	SK	EOC	A	D1	Cap. di chiusura Pinza "d" Capacity range "d"	Ghiera Nut
063.601.40.0350	SK 40	25	75	60	da 3 a 25	245.48.0350
063.601.40.0352	SK 40	25	120	60	da 3 a 25	245.48.0350
063.601.40.0440	SK 40	32	85	72	da 4 a 32	245.60.0440
063.601.40.0442	SK 40	32	120	72	da 4 a 32	245.60.0440
065.601.50.0350	SK 50	25	85	60	da 3 a 25	245.48.0350
065.601.50.0352	SK 50	25	120	60	da 3 a 25	245.48.0350
065.601.50.0440	SK 50	32	90	72	da 4 a 32	245.60.0440
065.601.50.0442	SK 50	32	130	72	da 4 a 32	245.60.0440

ACCESSORI PER MACCHINE UTENSILI



Mandrini portapinze Delta per pinze rif. art.209

Delta collet chucks for collets ref. art.209

Delta Spannzangenhalter für Spannzangen ref. art.209

Mandrins porte-pinces Delta pour pinces ref. art.209



MAS 403 BT

ART: 605 BT

3.
29

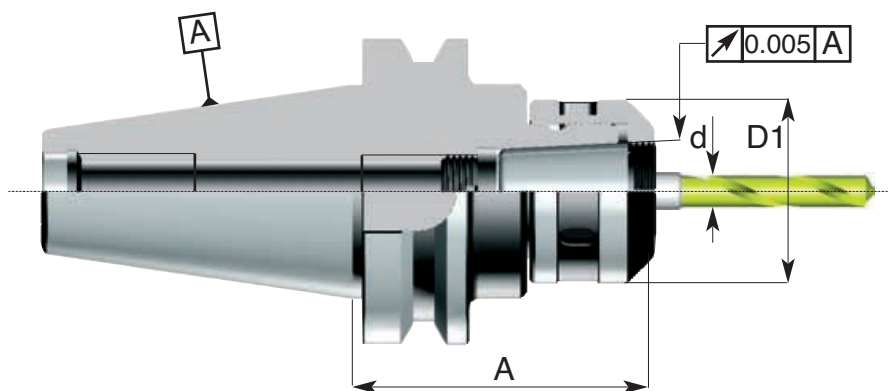

Codice di ord Code	SK	A	D1	Cap. di chiusura Pinza "d" Capacity range "d"	Tipo pinza Collet	Ghiera Nut
063.605.40.0320	SK 40	75	58	da 4 a 20	209.20	245.02
063.605.40.0440	SK 40	78	73	da 4 a 32	209.30	245.03
065.605.50.0320	SK 50	90	58	da 4 a 20	209.20	245.02
065.605.50.0440	SK 50	95	73	da 4 a 32	209.30	245.03

3. MANDRINI a cono ISO MAS 403 BT TOOL HOLDERS with ISO cone MAS 403 BT



Mandrini portapinzine ER DIN 6499 - ghiera standard

Collet chucks ER DIN 6499 - standard nut

Spannzangenhalter ER DIN 6499 - standard Spannmutter

Mandrins porte-pinces ER DIN 6499 - écrou standard

MAS 403 BT



Prebilanciato
Prebalanced
G6.3 / 8000rpm



Assortimento in cassetta pag: 3.33
Kit pag. 3.33

ACCESSORI PER MACCHINE UTENSILI



ART:607 BT
ghiera standard / standard nut

3.
30

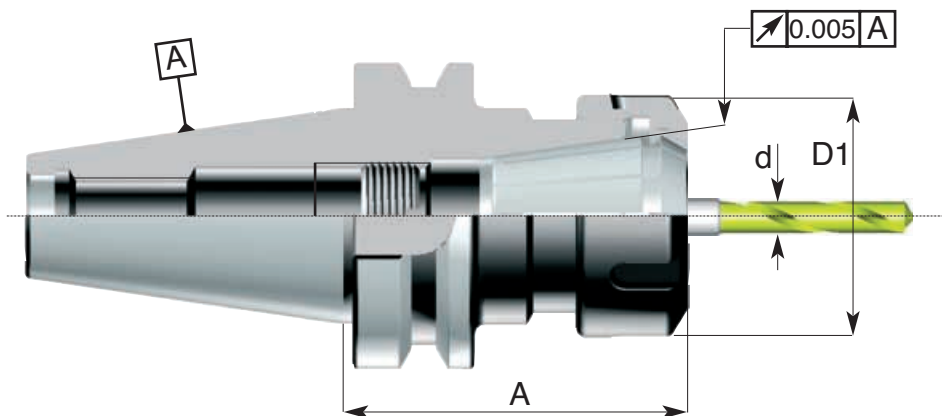

Codice di ord Code	SK	ER	A	D1	Cap. di chiusura Pinza "d" Capacity range "d"	Ghiera Nut
060.607.30.0160	SK 30	ER 16	60	28	da 0,5 a 10	245.22.ER16
060.607.30.0162	SK 30	ER 16	100	28	da 0,5 a 10	245.22. ER16
060.607.30.0200	SK 30	ER 20	60	34	da 1 a 13	245.25. ER20
060.607.30.0250	SK 30	ER 25	60	42	da 1 a 16	245.32.ER25
060.607.30.0252	SK 30	ER 25	100	42	da 1 a 16	245.32.ER25
060.607.30.0320	SK 30	ER 32	60	50	da 1 a 20	245.40.ER32
060.607.30.0322	SK 30	ER 32	100	50	da 1 a 20	245.40.ER32
060.607.30.0324	SK 30	ER 32	150	50	da 1 a 20	245.40.ER32
060.607.30.0400	SK 30	ER 40	70	63	da 2 a 30	245.50.ER40
061.607.35.0160	SK 35	ER 16	60	28	da 0,5 a 10	245.22.ER16
061.607.35.0200	SK 35	ER 20	60	34	da 0,5 a 13	245.25. ER20
061.607.35.0250	SK 35	ER 25	60	42	da 1 a 16	245.32.ER25
061.607.35.0320	SK 35	ER 32	60	50	da 1 a 20	245.40.ER32
063.607.40.0160	SK 40	ER 16	70	28	da 0,5 a 10	245.22.ER16
063.607.40.0162	SK 40	ER 16	120	28	da 0,5 a 10	245.22.ER16
063.607.40.0200	SK 40	ER 20	70	34	da 0,5 a 13	245.25. ER20
063.607.40.0202	SK 40	ER 20	120	34	da 0,5 a 13	245.25. ER20
063.607.40.0250	SK 40	ER 25	70	42	da 1 a 16	245.32.ER25
063.607.40.0252	SK 40	ER 25	120	42	da 1 a 16	245.32.ER25
063.607.40.0254	SK 40	ER 25	150	42	da 1 a 16	245.32.ER25
063.607.40.0320	SK 40	ER 32	70	50	da 1 a 20	245.40.ER32
063.607.40.0321	SK 40	ER 32	100	50	da 1 a 20	245.40.ER32
063.607.40.0322	SK 40	ER 32	120	50	da 1 a 20	245.40.ER32
063.607.40.0324	SK 40	ER 32	150	50	da 1 a 20	245.40.ER32
063.607.40.0400	SK 40	ER 40	70	63	da 2 a 30	245.50.ER40
063.607.40.0402	SK 40	ER 40	120	63	da 2 a 30	245.50.ER40
065.607.50.0160	SK 50	ER 16	75	28	da 0,5 a 10	245.22.ER16
065.607.50.0200	SK 50	ER 20	90	34	da 0,5 a 13	245.25. ER20
065.607.50.0250	SK 50	ER 25	90	42	da 1 a 16	245.32.ER25
065.607.50.0252	SK 50	ER 25	120	42	da 1 a 16	245.32.ER25
065.607.50.0320	SK 50	ER 32	90	50	da 1 a 20	245.40.ER32
065.607.50.0322	SK 50	ER 32	120	50	da 1 a 20	245.40.ER32
065.607.50.0324	SK 50	ER 32	150	50	da 1 a 20	245.40.ER32
065.607.50.0400	SK 50	ER 40	90	63	da 2 a 30	245.50.ER40
065.607.50.0402	SK 50	ER 40	120	63	da 2 a 30	245.50.ER40

ACCESSORI PER MACCHINE UTENSILI



Mandrini portapinze ER DIN 6499 - ghiera standard
 Collet chucks ER DIN 6499 - standard nut
 Spannzangenhalter ER DIN 6499 - standard Spannmutter
 Mandrins porte-pinces ER DIN 6499 - écrou standard

Prebilanciato
 Prebalanced
 G6.3 / 8000rpm



MAS 403 BT/B

ART: H607 BT/B
 ghiera standard / standard nut

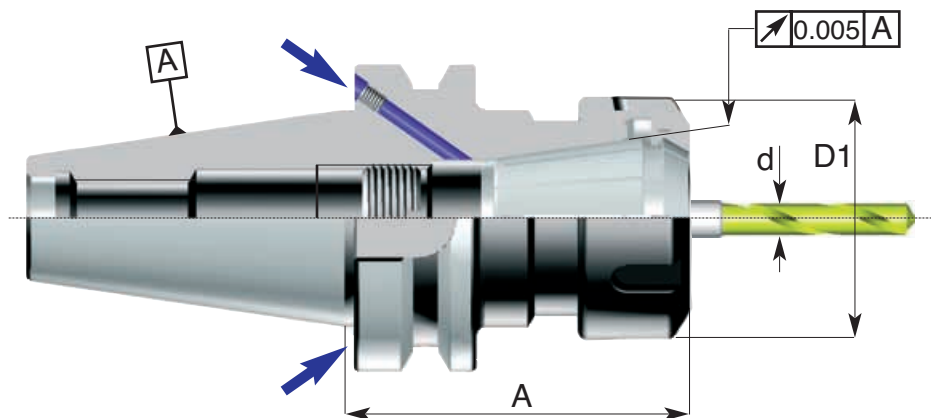

3.
31

Pinze / Collets
 pag: 12.6

Ghiera / Nuts
 pag: 12.13

Codice di ord Code	SK	ER	A	D1	Cap. di chiusura Pinza "d" Capacity range "d"	Ghiera Nut
H63.607.40.0164	SK 40	ER 16	150	28	da 0,5 a 10	245.22.ER16
H63.607.40.0166	SK 40	ER 16	200	28	da 0,5 a 10	245.22.ER16
H63.607.40.0204	SK 40	ER 20	150	34	da 0,5 a 13	245.25.ER20
H63.607.40.0250	SK 40	ER 25	60	42	da 1 a 16	245.32.ER25
H63.607.40.0252	SK 40	ER 25	120	42	da 1 a 16	245.32.ER25
H63.607.40.0254	SK 40	ER 25	150	42	da 1 a 16	245.32.ER25
H63.607.40.0256	SK 40	ER 25	200	42	da 1 a 16	245.32.ER25
H63.607.40.0320	SK 40	ER 32	70	50	da 1 a 20	245.40.ER32
H63.607.40.0322	SK 40	ER 32	120	50	da 1 a 20	245.40.ER32
H63.607.40.0324	SK 40	ER 32	150	50	da 1 a 20	245.40.ER32
H63.607.40.0326	SK 40	ER 32	200	50	da 1 a 20	245.40.ER32
H63.607.40.0400	SK 40	ER 40	70	63	da 2 a 30	245.50.ER40
H63.607.40.0402	SK 40	ER 40	120	63	da 2 a 30	245.50.ER40
H65.607.50.0250	SK 50	ER 25	90	42	da 1 a 16	245.32.ER25
H65.607.50.0252	SK 50	ER 25	120	42	da 1 a 16	245.32.ER25
H65.607.50.0320	SK 50	ER 32	90	50	da 1 a 20	245.40.ER32
H65.607.50.0322	SK 50	ER 32	120	50	da 1 a 20	245.40.ER32
H65.607.50.0324	SK 50	ER 32	150	50	da 1 a 20	245.40.ER32
H65.607.50.0400	SK 50	ER 40	90	63	da 2 a 30	245.50.ER40
H65.607.50.0402	SK 50	ER 40	120	63	da 2 a 30	245.50.ER40

3. MANDRINI a cono ISO MAS 403 BT TOOL HOLDERS with ISO cone MAS 403 BT



Mandri portapinz ER DIN 6499 - ghiera mini
Collet chucks ER DIN 6499- mini nut
Spannzangenhalter ER DIN 6499 - mini Spannmutter
Mandriins porte-pinces ER DIN 6499 - écrou mini

ACCESSORI PER MACCHINE UTENSILI

MAS 403 BT/B



Prebilanciato
Prebalanced
G6.3 / 8000rpm



ART: H607 BT/B
ghiera mini / mini nut

3.
32

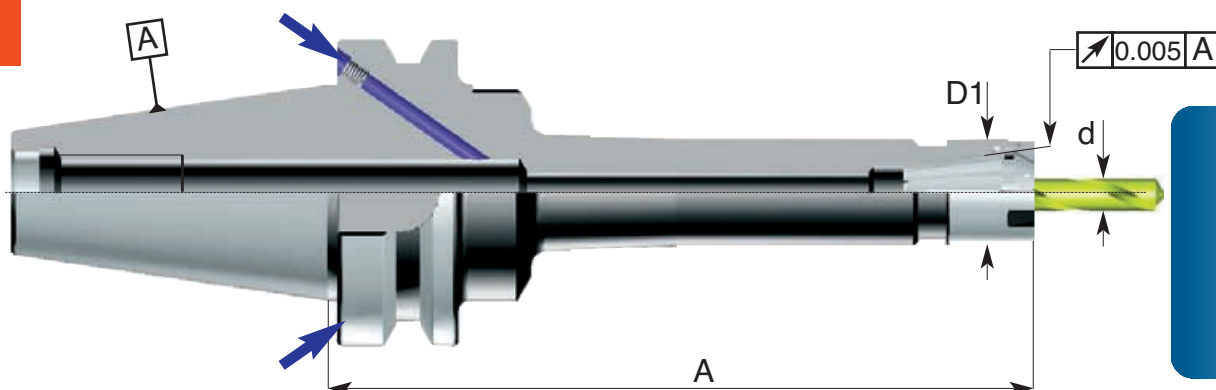

Pinze / Collets
pag: 12.6

Ghiere / Nuts
pag: 12.13

Codice di ord Code	SK	ER	A	D1	Cap. di chiusura Pinza "d" Capacity range "d"	Ghiera Nut
H63.607.40.0112M	SK 40	ER 11	100	16	da 0,5 a 7	245.13.ER11M
H63.607.40.0114M	SK 40	ER 11	150	16	da 0,5 a 7	245.13.ER11M
H63.607.40.0162M	SK 40	ER 16	100	22	da 0,5 a 10	245.19.ER16M
H63.607.40.0164M	SK 40	ER 16	150	22	da 0,5 a 10	245.19.ER16M
H63.607.40.0252M	SK 40	ER 25	100	35	da 1 a 16	245.24.ER25M
H63.607.40.0254M	SK 40	ER 25	150	35	da 1 a 16	245.24.ER25M
H65.607.50.0164M	SK 50	ER 16	150	22	da 0,5 a 10	245.19.ER16M
H65.607.50.0254M	SK 50	ER 25	150	35	da 1 a 16	245.24.ER25M

Cassette con portapinze ER pinze complete di chiave di serraggio

Boxes with ER collet chucks and collets - supplied with wrench

Kassetten mit Spannzangenhalter ER und Spannzangen - geliefert mit Schlüssel

Coffrets avec mandrins à pinces ER et pinces - fournis avec clé



MAS 403 BT

CASSETTE BT

ART: 060... / 063... / 065...

3.
33



Codice di ord. <i>Code</i>	Mandrino <i>Chuck</i>	SK	Tipo pinza <i>Collets type</i>	Numero pinze <i>Collets nr.</i>	Ø Pinza <i>Ø Collets</i>
060.30.09.ER32	060.607.30.0320	BT30	ER32	9	4-6-8-10-12-14-16-18-20
060.30.18.ER32	060.607.30.0320	BT30	ER32	18	da 3 a 20
063.40.09.ER32	063.607.40.0320	BT40	ER32	9	4-6-8-10-12-14-16-18-20
063.40.18.ER32	063.607.40.0320	BT40	ER32	18	da 3 a 20
063.40.09.ER40	063.607.40.0400	BT40	ER40	9	4-6-8-10-12-14-16-18-20
063.40.23.ER40	063.607.40.0400	BT40	ER40	23	da 4 a 26
065.50.09.ER32	065.607.50.0320	BT50	ER32	9	4-6-8-10-12-14-16-18-20
065.50.18.ER32	065.607.50.0320	BT50	ER32	18	da 3 a 20
065.50.09.ER40	065.607.50.0400	BT50	ER40	9	4-6-8-10-12-14-16-18-20
065.50.23.ER40	065.607.50.0400	BT50	ER40	23	da 4 a 26

3. MANDRINI a cono ISO MAS 403 BT

TOOL HOLDERS with ISO cone MAS 403 BT



Mandrini per astucci registrabili e portautensili con gambo a norma DIN 6327

Adaptors for adjustable inserts DIN 6327

Zwischenhülsen für axialverstellbare Futter DIN 6327

Douilles pour mandrins réglables axialement DIN 6327

ACCESSORI PER MACCHINE UTENSILI

MAS 403 BT



ART:610 BT

3.
34

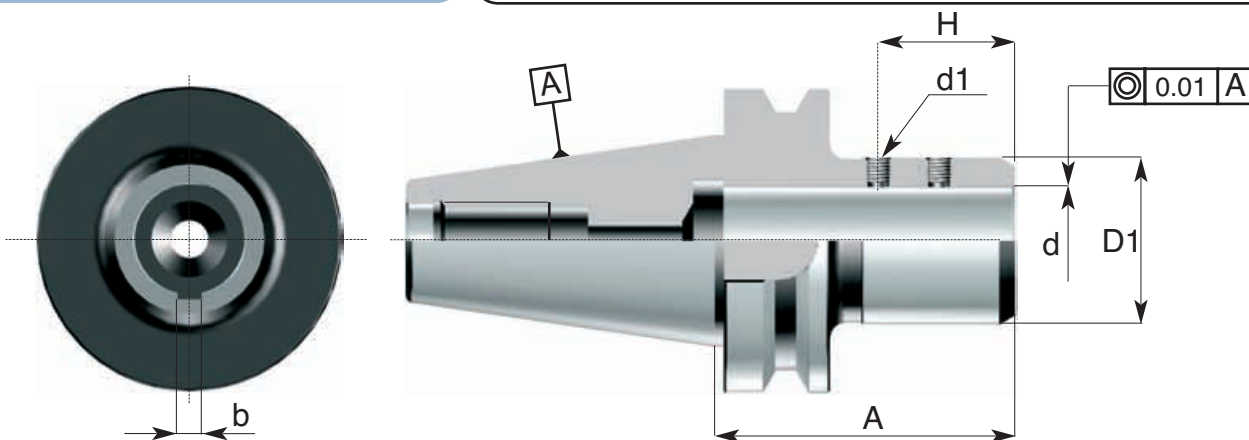

Codice di ord Code	SK	d h7	A	D1	H	b C11	Grano di serraggio "d1" Clamping screw "d1"
063.610.40.0250	SK 40	25	90	45	38	6	610.00.0080
063.610.40.0280	SK 40	28	85	45	38	8	610.00.0080
063.610.40.0360	SK 40	36	115	55	45	8	610.00.0080
065.610.50.0280	SK 50	28	100	55	38	6	610.00.0060
065.610.50.0360	SK 50	36	100	60	45	8	610.00.0080
065.610.50.0480	SK 50	48	120	75	57	10	610.00.0100



ACCESSORI PER MACCHINE UTENSILI



Maschiatori a cambio rapido con compensazione elastica assiale a trazione e pressione

Quick-change tapping chuck with compensation in compression and tension

Gewindeschneid- und Schnellwechselfutter mit Ausgleich auf Druck und Zug

Mandrin à tarauder à changement rapide avec compensation longitudinale et de la traction



MAS 403 BT

ART: 638 BT

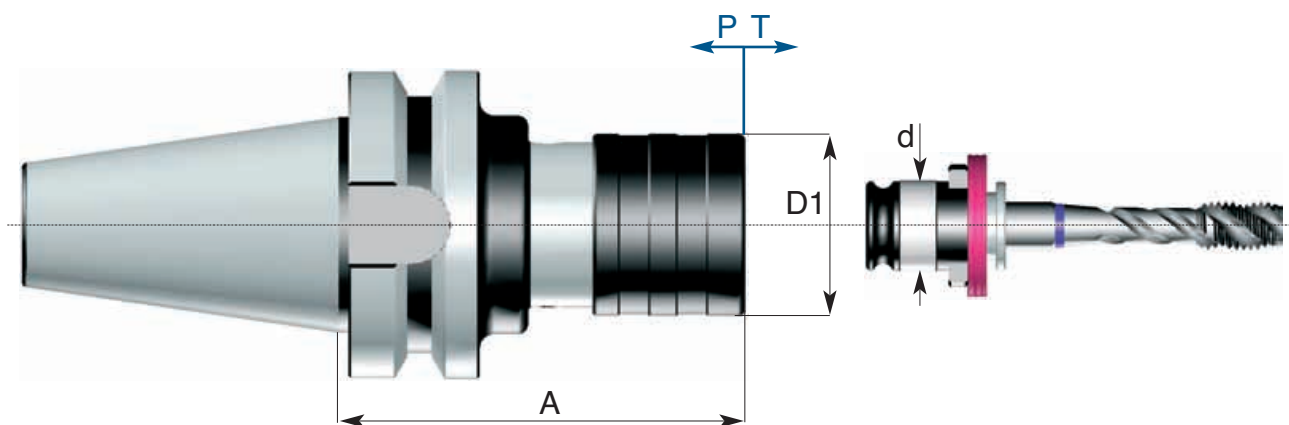

3.
35

Codice di ord Code	SK	A	D1	d	Capacità maschiatore Tapping capacity	Compensazione assiale T Axial compensation P	
060.638.30.1205	SK 30	70	35	19	M3 - M14	5	7
060.638.30.2008	SK 30	95	53	31	M8 - M24	12	13
063.638.40.1205	SK 40	80	35	19	M3 - M14	5	7
063.638.40.2008	SK 40	101	53	31	M8 - M24	12	13
063.638.40.3310	SK 40	148	78	48	M14 - M36	15	20
065.638.50.1205	SK 50	90	35	19	M3 - M14	5	7
065.638.50.2008	SK 50	115	53	31	M8 - M24	12	13
065.638.50.3310	SK 50	145	78	48	M14 - M36	15	20



3. MANDRINI a cono ISO MAS 403 BT TOOL HOLDERS with ISO cone MAS 403 BT



Maschiatori a cambio rapido senza compensazione per maschiatura rigida
Quick-change tapping chuck without compensation for rigid tapping
Gewindeschneid- und Schnellwechselfutter ohne Ausgleich für Synchronisation
Mandrin à tarauder à changement rapid sans compensation pour taraudage synchronisé

ACCESSORI PER MACCHINE UTENSILI



MAS 403 BT



ART:648 BT

3.
36

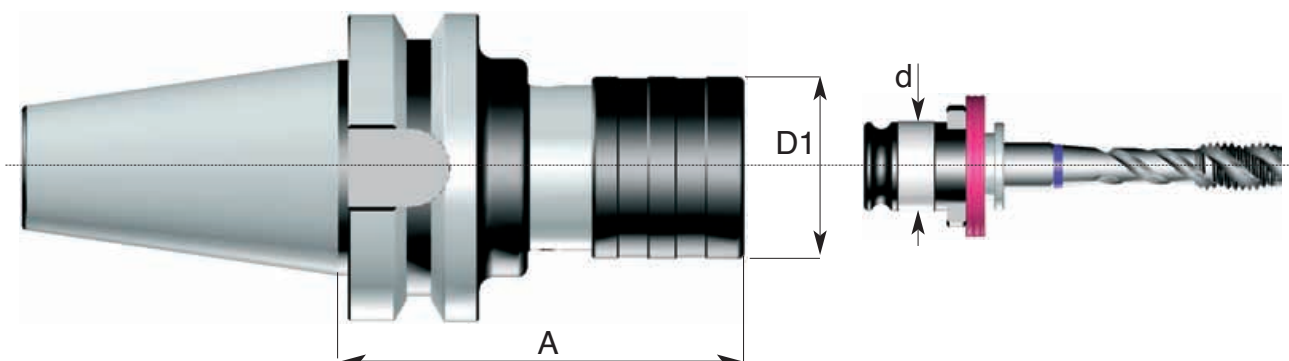

Codice di ord Code	SK	A	D1	d	Capacità maschiatore Tapping capacity
060.648.30.1200	SK 30	70	32	19	M 3 - M 14
060.648.30.2000	SK 30	98	50	31	M 8 - M 24
063.648.40.1200	SK 40	85	32	19	M 3 - M 14
063.648.40.2000	SK 40	85	50	31	M 8 - M 24
063.648.40.3300	SK 40	110	72	48	M 14 - M 36
065.648.50.1200	SK 50	80	32	19	M 3 - M 14
065.648.50.2000	SK 50	90	50	31	M 8 - M 24
065.648.50.3300	SK 50	115	72	48	M 14 - M 36



ACCESSORI PER MACCHINE UTENSILI



Attacchi base per sistema modulare tipo "VARILOCK"

Attachments for modular system - type "VARILOCK"

Grundaufnahmen für Modulare Werkzeugsystem - Type "VARILOCK"

Attachements pour système modulaire - type "VARILOCK"



MAS 403 BT/B

ART:HVAR BT/B

3.
37

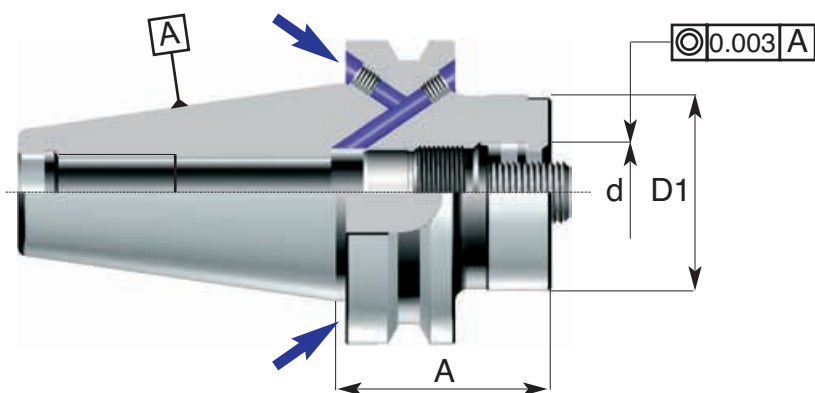

Codice di ord Code	SK	A	D1	d	Vite Screw	Ghiera Nut
H63.VAR.40.0500	SK 40	50	50	27	VAR.00.0500.20	VAR.00.0500.10
H63.VAR.40.0630	SK 40	50	63	32	VAR.00.0630.20	VAR.00.0630.10
H65.VAR.50.0502	SK 50	50	50	27	VAR.00.0500.20	VAR.00.0500.10
H65.VAR.50.0632	SK 50	50	63	32	VAR.00.0800.20	VAR.00.0800.10
H65.VAR.50.0802	SK 50	50	80	32	VAR.00.0800.20	VAR.00.0800.10



4.2

- Portafrese combinati
Combined milling cutter chucks

4.2

- Portapinze ER DIN 6499
Collet chucks ER DIN 6499

4.3

- Portafrese weldon
Milling cutter chucks Weldon

4.3

- Maschiatori
Tapping chuck



for CHIRON
Attacchi con
cono ISO 30
Attachments
with ISO cone

4

 **delta**

4. MANDRINI CHIRON ISO 30

TOOL HOLDERS CHIRON ISO 30



Portafrese combinati con trascinamento frontale e chiavetta DIN 6358

Combined milling cutter chucks DIN 6358 B

Kombi-Aufsteckfräserdorne DIN 6358 B

Mandrins porte-fraises combinés DIN 6358 B

ACCESSORI PER MACCHINE UTENSILI



CHIRON ISO 30

ART: CHI.130

4
2

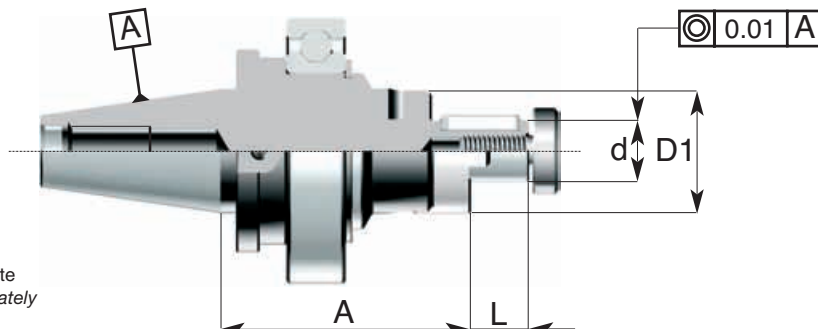

Cuscinetto da ordinare a parte
Bearing to be ordered separately

Codice di ord Code	SK	d h6	A	L	L1	D1	Trascinatore Ring	Vite Screw	Linguetta Key
CHI.130.30.0160	SK 30	16	62	17	27	32	190.01	191.01	130.199.01
CHI.130.30.0220	SK 30	22	62	19	31	40	190.02	191.02	130.199.02
CHI.130.30.0270	SK 30	27	62	21	33	50	190.03	191.03	130.199.03
CHI.130.30.0320	SK 30	32	62	24	38	58	190.04	191.04	130.199.04

Portafrese cilindriche tipo weldon con vite di registrazione interna DIN 6359 B

Milling cutter chucks for straight-shank tools - Weldon System DIN 6359 B

Spannfutter Weldon für Zylinderschäfte DIN 6359 B

Mandrins porte-Weldon pour fraises à queue cylindrique DIN 6359 B

CHIRON ISO 30

ART: CHI.208

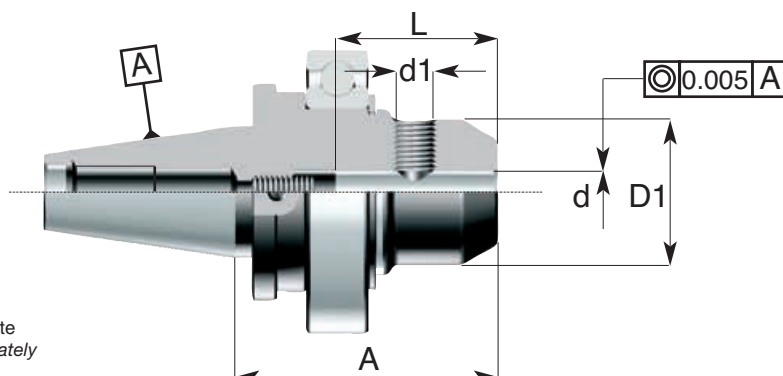

Cuscinetto da ordinare a parte
Bearing to be ordered separately

Codice di ord Code	SK	d H5	A	D1	L	d1	Grano di serraggio Clamping screw
CHI.208.30.0060	SK 30	6	63	25	35	M6X10	208.00.0060
CHI.208.30.0080	SK 30	8	63	28	35	M8X10	208.00.0080
CHI.208.30.0100	SK 30	10	63	35	39	M10X12	208.00.0100
CHI.208.30.0120	SK 30	12	65	40	44	M12X1,5X16	208.00.0120
CHI.208.30.0160	SK 30	16	65	48	47	M14X1,5X16	208.00.0140
CHI.208.30.0200	SK 30	20	70	50	49	M16X1,5X16	208.00.0160

ACCESSORI PER MACCHINE UTENSILI



Mandrini portapinze ER DIN 6499
 Collet chucks ER DIN 6499
 Spannzangenhalter ER DIN 6499
 Mandrins porte-pinces ER DIN 6499

CHIRON ISO 30

ART: CHI.607

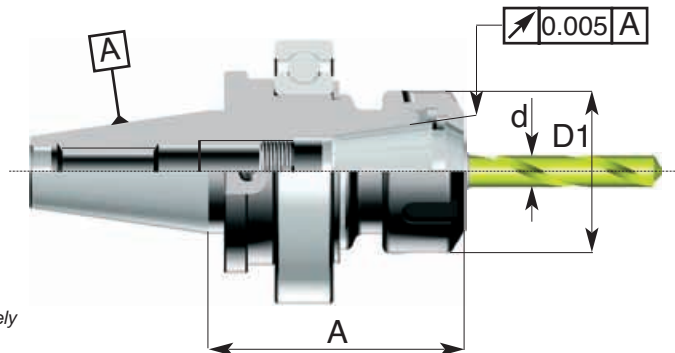

Cuscinetto da ordinare a parte
 Bearing to be ordered separately



4.
3

Codice di ord Code	SK	ER	A	D1	Cap. di chiusura Pinza "d" Capacity range "d"	Ghiera Nut
CHI.607.30.0160	SK 30	ER 16	65	28	da 1 a 10	245.22.ER16
CHI.607.30.0250	SK 30	ER 25	65	42	da 2 a 16	245.32.ER25
CHI.607.30.0320	SK 30	ER 32	70	50	da 2 a 20	245.40.ER32
CHI.607.30.0322	SK 30	ER 32	120	50	da 2 a 20	245.40.ER32
CHI.607.30.0324	SK 30	ER 32	150	50	da 2 a 20	245.40.ER32
CHI.607.30.0326	SK 30	ER 32	180	50	da 2 a 20	245.40.ER32
CHI.607.30.0400	SK 30	ER 40	80	63	da 4 a 26	245.50.ER40



Maschiatori a cambio rapido con compensazione elastica assiale a trazione e pressione
 Quick-change tapping chuck with compensation in compression and tension
 Gewindeschneid- und Schnellwechselfutter mit Ausgleich auf Druck und Zug
 Mandrin à tarauder à changement rapid avec compensation longitudinale et de la traction

CHIRON ISO 30

ART: CHI.638

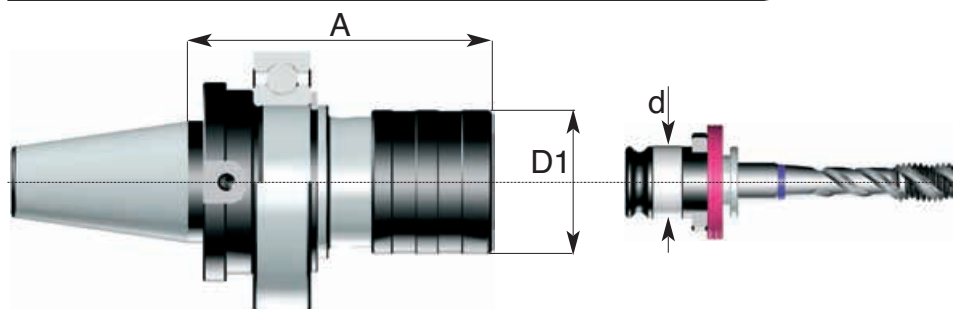

Cuscinetto da ordinare a parte
 Bearing to be ordered separately



Codice di ord Code	SK	A	D1	d	Capacità maschiatore Tapping capacity	Compensazione assiale T Axial compensation P
CHI.638.30.1205	SK 30	60	35	19	M3 - M14	5 7

4. MANDRINI CHIRON ISO 30

TOOL HOLDERS CHIRON ISO 30



Cuscinetto a sfere per macchine tipo CHIRON fz 16, fz 20, fz 25

Bearing - for chiron fz 16, fz 20, fz 25

Lager - für chiron fz 16, fz 20, fz 25

Roulement - pour chiron fz 16, fz 20, fz 25

ACCESSORI PER MACCHINE UTENSILI



CHIRON ISO 30

ART:CHI.6008.2RS1

4
4

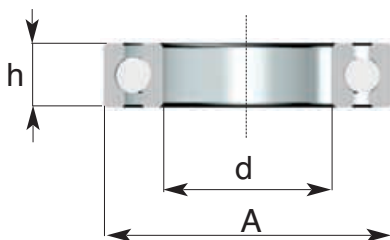

Codice di ord Code	D	d	h
CHI.6008.2RS1	68	40	15



www.mecadiffusion.com



www.delta-spa.com



PORTAUTENSILI A CONO ISO DIN 2088 E MORSE PER MACCHINE UTENSILI TRADIZIONALI
CONTROPUNTE ROTANTI E FISSE - MANDRINI MASCHIATORI A CAMBIO RAPIDO
TOOLHOLDERS FOR MILLING AND BORING MACHINES WITH ISO AND MORSE
PRECISION RUNNING TAIL CENTERS - QUICK CHANGE TAPPING CHUCKS

PORTAUTENSILI A CONO ISO DIN 69871/A-B, CAT E MAS BT 405 PER CENTRI DI LATO
A CONTROLLO NUMERICO
TOOLHOLDERS FOR CNC MACHINERY WITH ISO DIN 69871/A-B, CAT AND MAS BT 405

PORTAUTENSILI CON ATTACCO HSK DIN 69893 FORMA A -
TOOLHOLDERS WITH HSK TAPER DIN 69893 FORM A

MANDRINO HYDRO DELTA A CHIUSURA IDRAULICA
HYDRO DELTA CHUCKS HYDRAULIC CLAMP

PORTAUTENSILI PER TORNI A CONTROLLO NUMERICO DIN 69880 UDI 3
TOOLHOLDERS FOR NC LATHES DIN 69880 UDI 3

MANDRINI MACCHINA PRINCIPALI - PORTAUTENSILI SPECIALI A DISEGNO CLIENTI
MACHINE MAIN SPINDLES - SPECIAL TOOLHOLDERS ON CUSTOMER'S REQUEST